

Trend Synergy[®] Aluminium

Awning Window

TECHNICAL DATA - NSW/ACT/VIC

Features & Benefits

Size Range

Ordering Details

Installation

Cross Sectional Views

Features & Benefits - NSW/ACT/VIC

Synergy® Awning Window

- 1 **Energy Efficiency Options**
To reduce energy consumption, Thermashield® systems are available in various WERS ratings and glazing styles.
- 2 **Acoustic Options**
SoundMizer® acoustic solutions are available for awning windows. SoundMizer® acoustic solutions can reduce aircraft, highway traffic, railway and other annoying noise problems. For information or technical details contact Synergy®.
- 3 **Key Lock Chain Winder**
Awning window winder mechanism is designed specifically for high performance, security and reliability. Supplied with a stainless steel chain as standard for long life and reliability, the mechanisms are mounted securely to the window with a concealed 2-point fixing. Key lock is standard for added security.
- 4 **Continuous Hinge Hood**
The sash is protected from the weather by a continuous hinge hood that supports the sash and keeps the rain where it belongs - on the outside.
- 5 **Weather Protection**
The tubular splayed sash, with self-draining trough, assists the continuous surround bulb seal to protect against even the most adverse weather conditions.
- 6 **Sash Corner Protection**
The bottom rail sash corners are protected by a custom nylon cover that acts as a sash guide into the frame.
- 7 **Glazing**
Trend's Synergy® sash is available in double glazing and special

laminates for energy efficiency applications. Acoustic solutions are also available to high STC ratings.

- 8 **Complementary Accessories**
 - 180° non-load bearing couplers, two types available for added mullion strength when required.
 - 135° & 90° non-load-bearing corner couplers to suit bay and kitchen windows.
 - 100mm aluminium architraves for replacement window installations.
 - Adjustable aluminium storm mould.
 - Aluminium 180° and 90° mullion covers to hide load-bearing posts.
- 9 **Options**
Easy to fit tension loaded flyscreens can be fitted and removed from the inside.
Wide range of powdercoat finishes available.

Bushfire Protection
Xtreme® BAL-40 bushfire protection is available for bushfire areas



Xtreme® bushfire protection awning window has been tested by CSIRO to BAL-40, which is fully compliant to AS1530.8.1 within AS3959-2009.

NOTE:

Window Placement
Care should be taken with locating opening awning windows in pedestrian traffic areas.

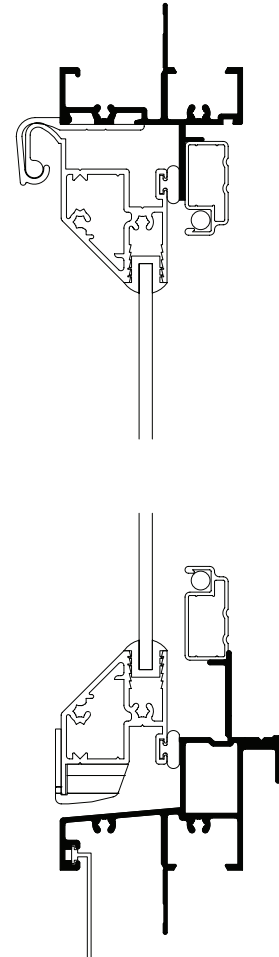

Size Range - NSW/ACT/VIC

Synergy® Awning Window

STUD OPENING WINDOW	656	780	899	1018	1258	1506	1847	2232	2589
	600	724	843	962	1202	1450	1791	2176	2533
646	AA0606	AA0607	AA0609	AA0610	AA0612	AA0614	AA0618	AA0622	AA0625
732	AA0706	AA0707	AA0709	AA0710	AA0712	AA0714	AA0718	AA0722	AA0725
989	AA0906	AA0907	AA0909	AA0910	AA0912	AA0914	AA0918	AA0922	AA0925
1076	AA1006	AA1007	AA1009	AA1010	AA1012	AA1014	AA1018	AA1022	AA1025
1247	AA1206	AA1207	AA1209	AA1210	AA1212	AA1214	AA1218	AA1222	AA1225
1418	AA1406	AA1407	AA1409	AA1410	AA1412	AA1414	AA1418	AA1422	AA1425
1856	AA1806T	AA1807T	AA1809T	AA1810T	AA1812T	AA1814T	AA1818T	AA1822T	AA1825T
2098	AA2006T	AA2007T	AA2009T	AA2010T	AA2012T	AA2014T	AA2018T	AA2022T	AA2025T
2098	AA2006	AA2007	AA2009						

All windows and doors are designed to 700pa velocity and 150pa water rating. For higher ratings consult Synergy® Windows & Doors

Ordering Details - NSW/ACT/VIC

Synergy® Awning Window

All windows are illustrated as viewed from outside. Codes shown are for plain windows.

Manufactured from 48mm aluminium extrusion. The first two numbers of code indicate approximate height, the last two numbers indicate approximate width.

Sash Style Options:

Standard option, eg window code AA0606

T indicates Thermashield® double glazed sash style, eg window code ATA0606

N indicates Sentinel sash style.

Eg window code ANA0606

M indicates Acoustic sash style (SoundMizer®), eg window code AMA0606

Bar Options:

CL indicates Colonial Bar, eg window code AA0606CL

FD indicates Federation Bar, eg window code AA0606FD

Configuration Options:

A indicates Awning

F indicates Fixed

AA indicates Awning\Awning

AF indicates Awning\Fixed

FA indicates Fixed\Awning

FF indicates Fixed\Fixed

AAA indicates Awning\Awning\Awning

AFA indicates Awning\Fixed\Awning

FAF indicates Fixed\Awning\Fixed

FFF indicates Fixed\Fixed\Fixed

T after the size indicates a Transom

E indicates Xtreme (placed at the end of the code)

Hardware Colour Options:

Black hardware is supplied as standard.

Optional hardware colours are Anodic Natural Matt, Stone Beige, Pearl White and Satin Chrome

Xtreme bushfire protection Awning windows that rates to BAL-40 are available for bushfire zones

Installation

Synergy® Awning Window | Building In Detail | **Brick Veneer - 230mm wall**

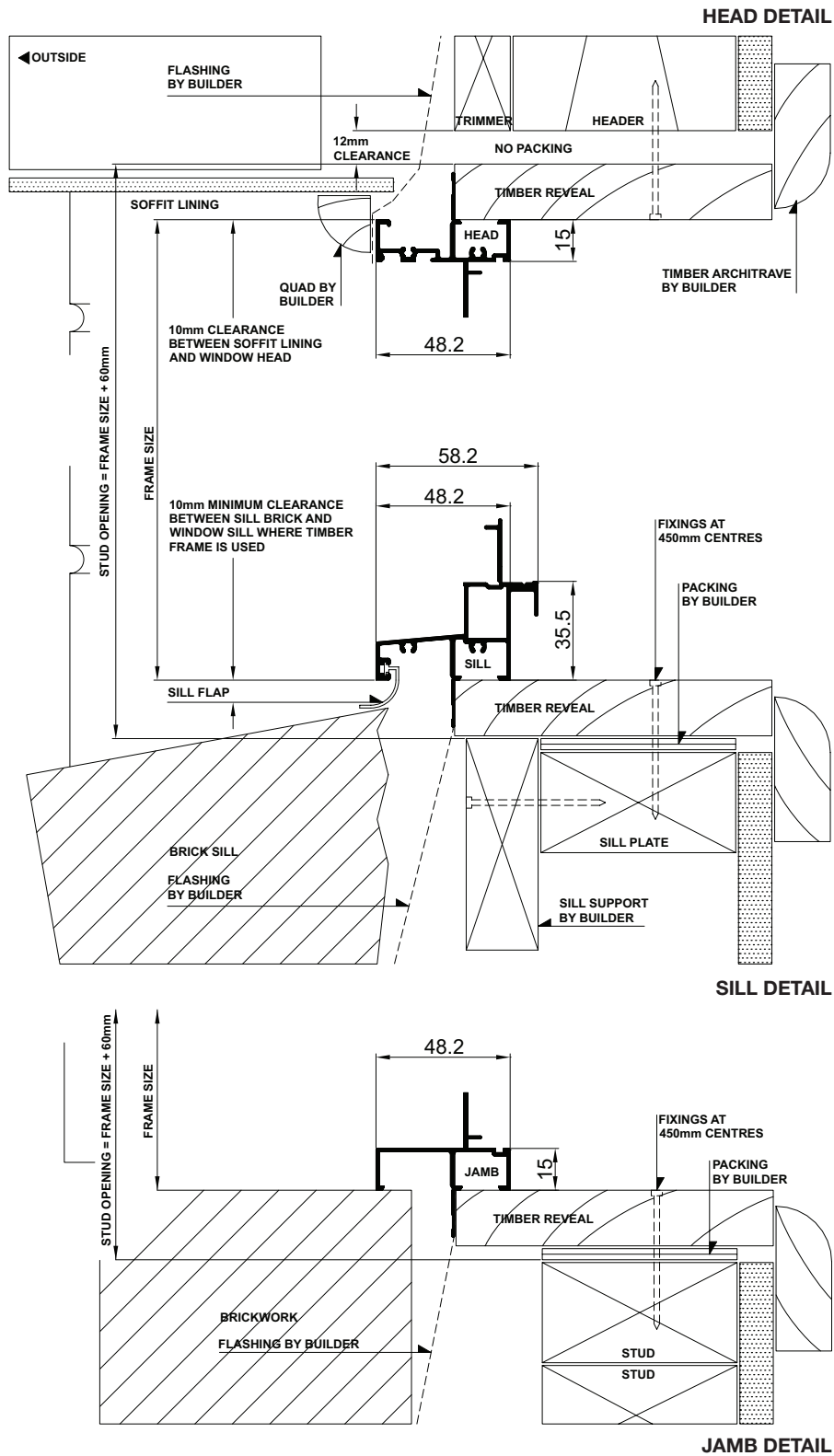

Installation

Synergy® Awning Window | Building In Detail | **Double Brick - 280mm wall**

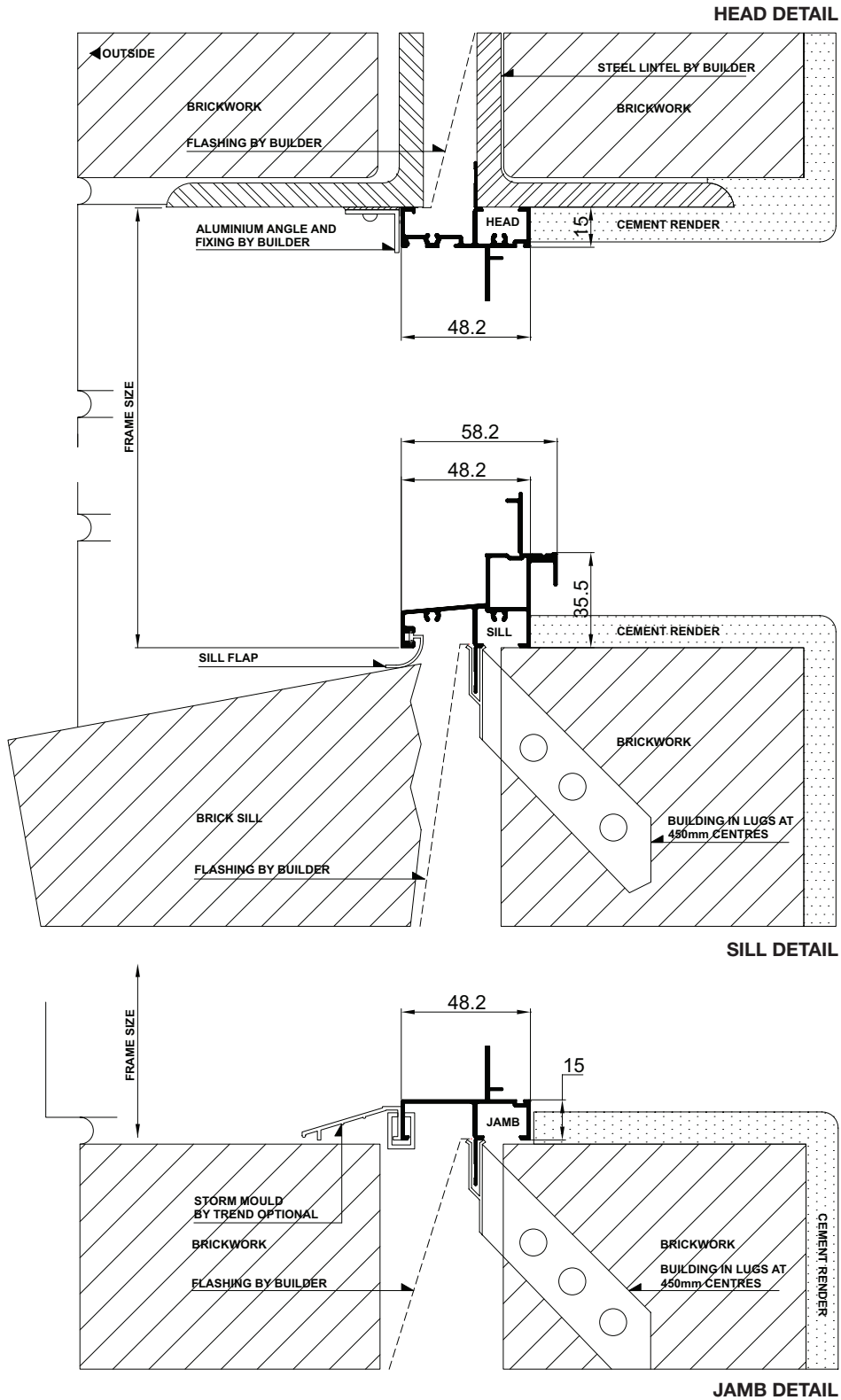

Installation

Synergy® Awning Window | Building In Detail | Aluminium Cladding on Studs

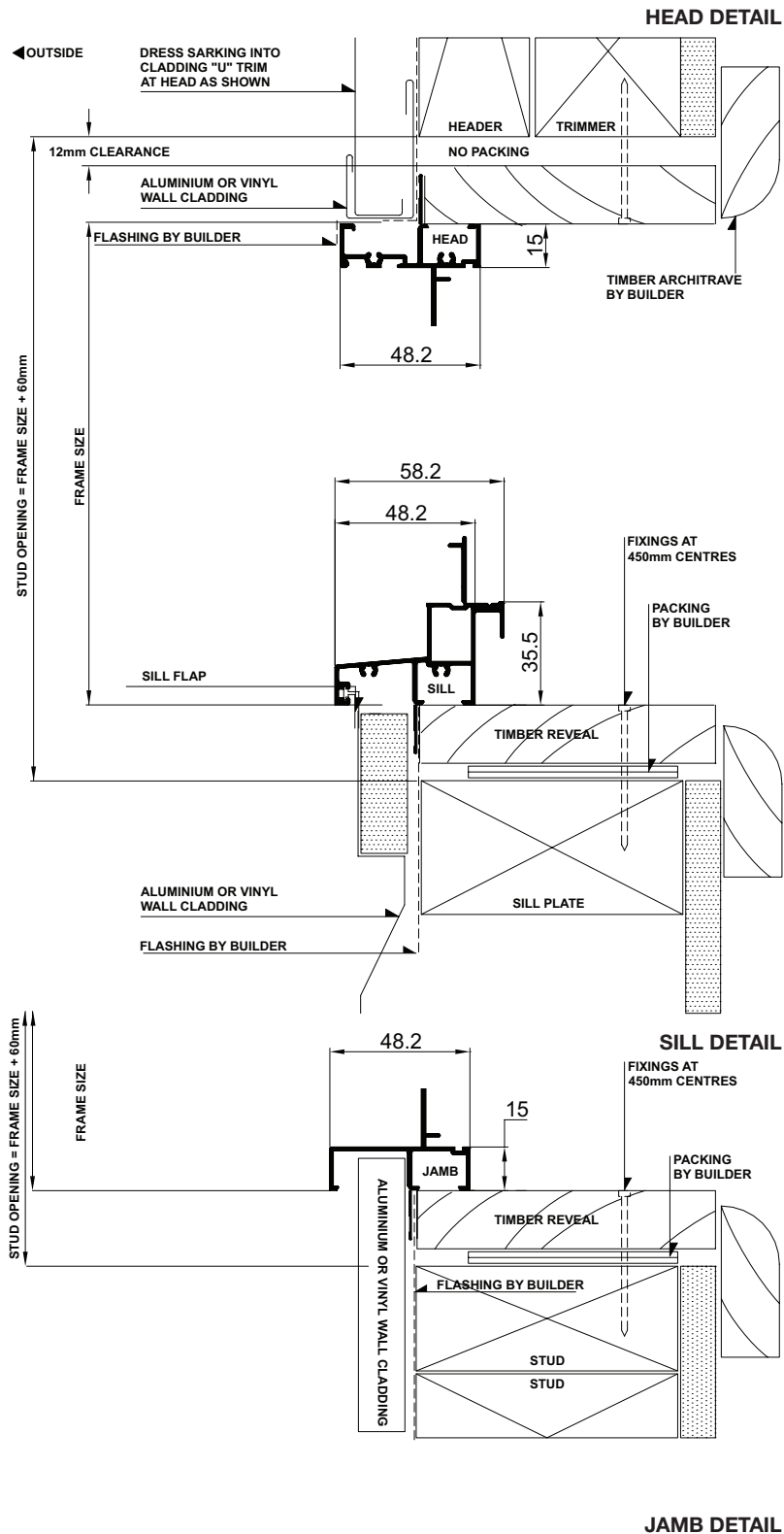

Cross Sectional Views

Synergy® Awning Window | **Single Lite** | NSW/ACT

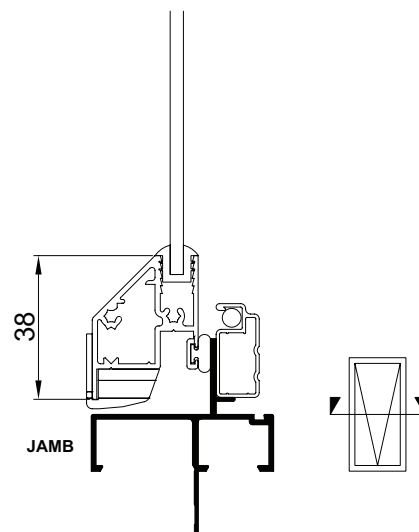
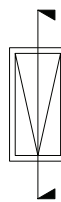
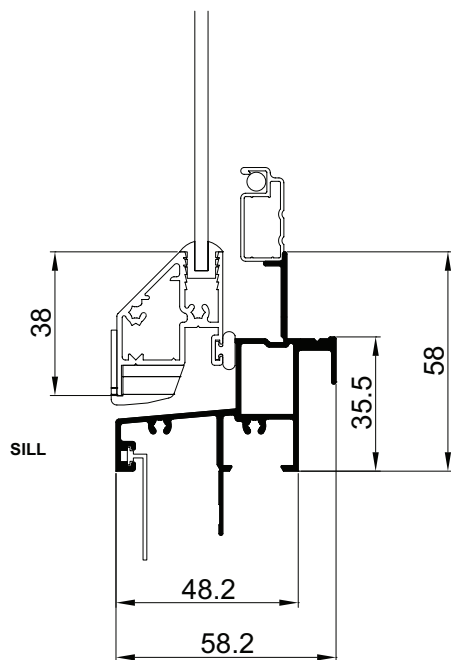
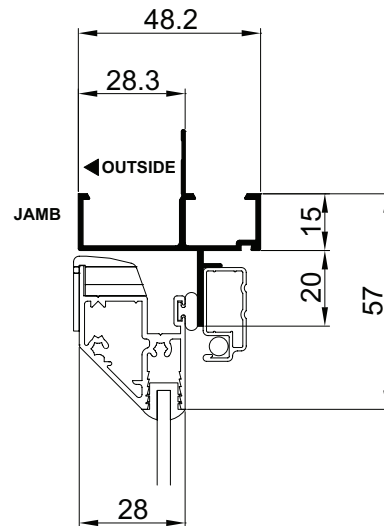
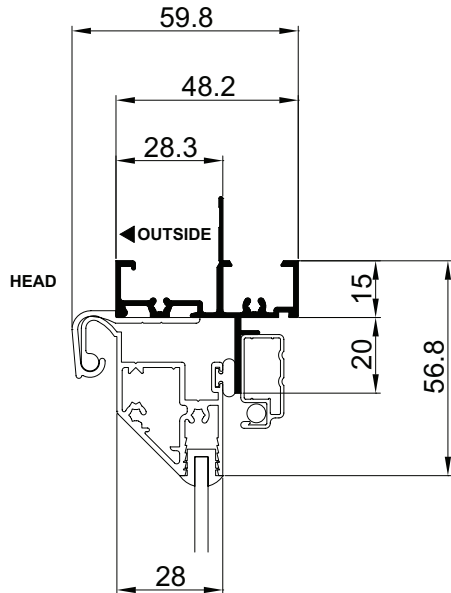

Cross Sectional Views

Synergy® Awning Window | Two Lite with Lowlite | NSW/ACT

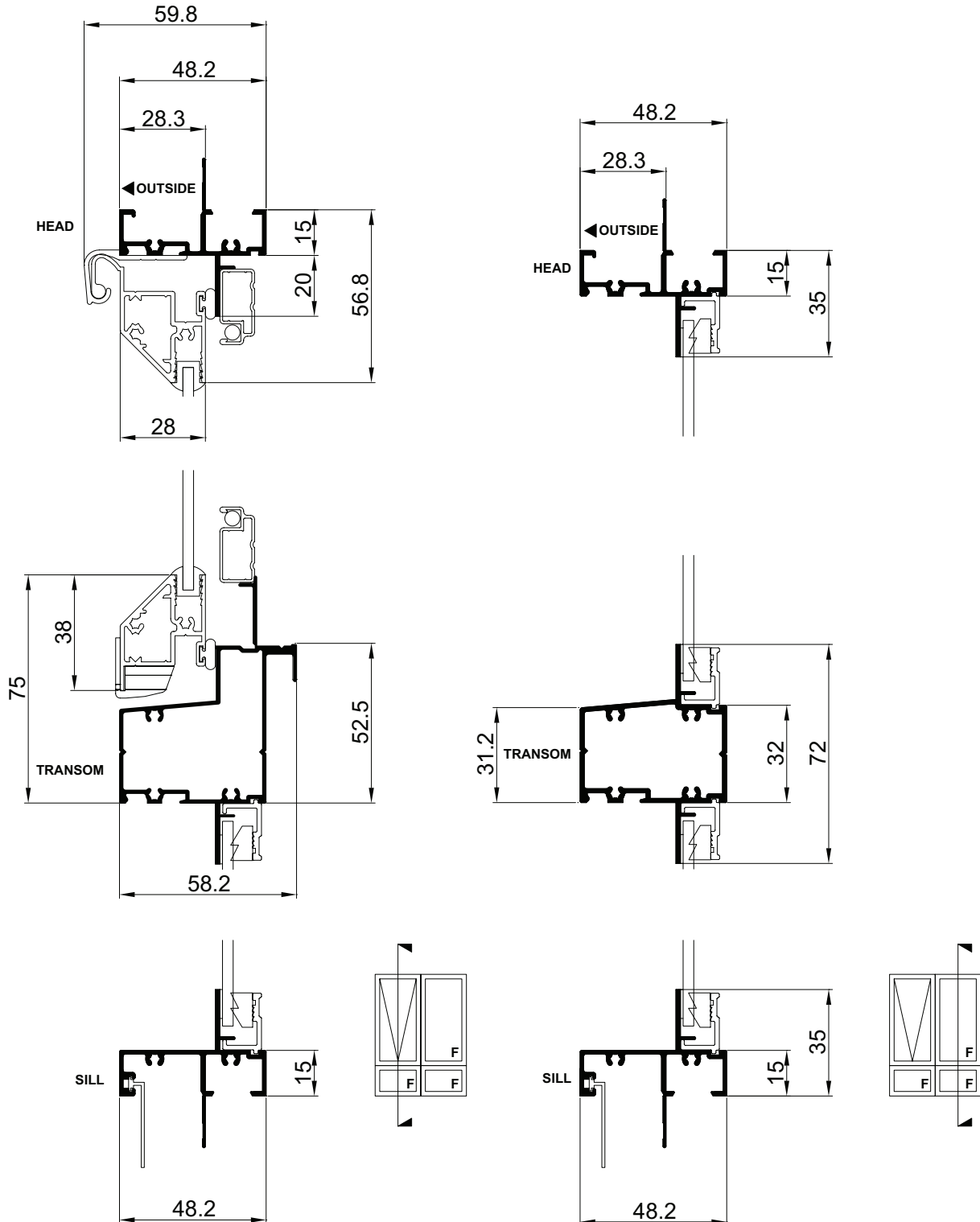

Cross Sectional Views

Synergy® Awning Window | **Two Lite with Lowlite** | NSW/ACT

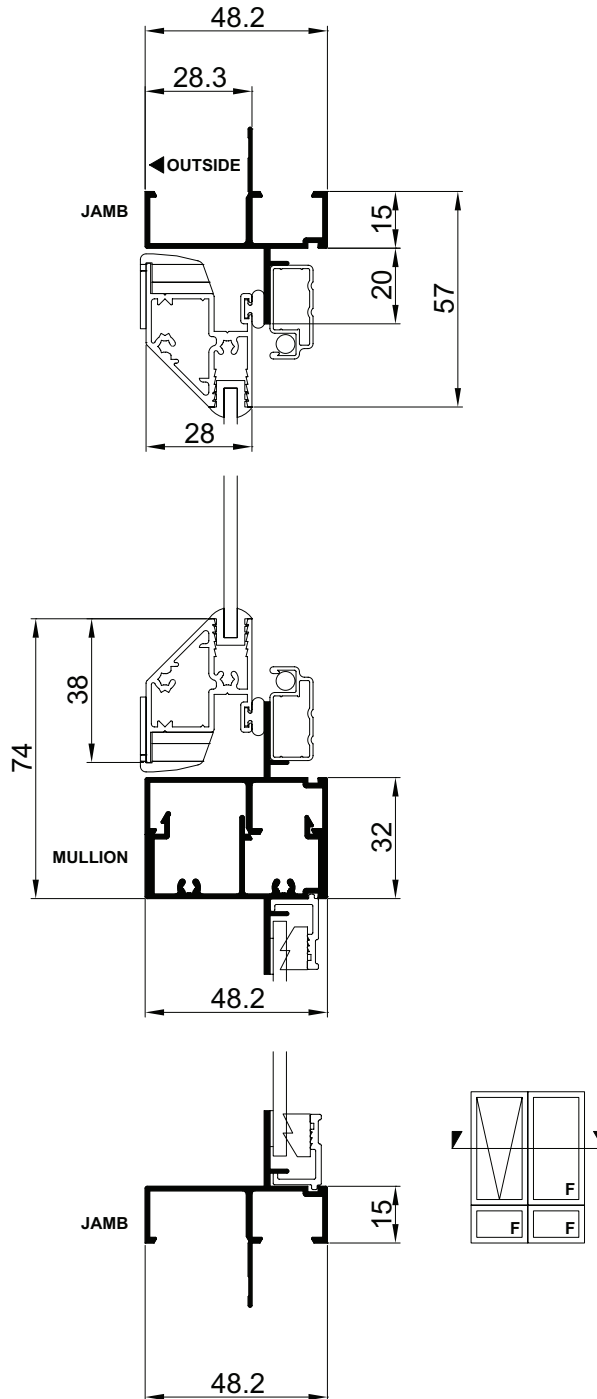

Cross Sectional Views

Synergy® Awning Window | **Single with Hilite and Lowlite** | NSW/ACT

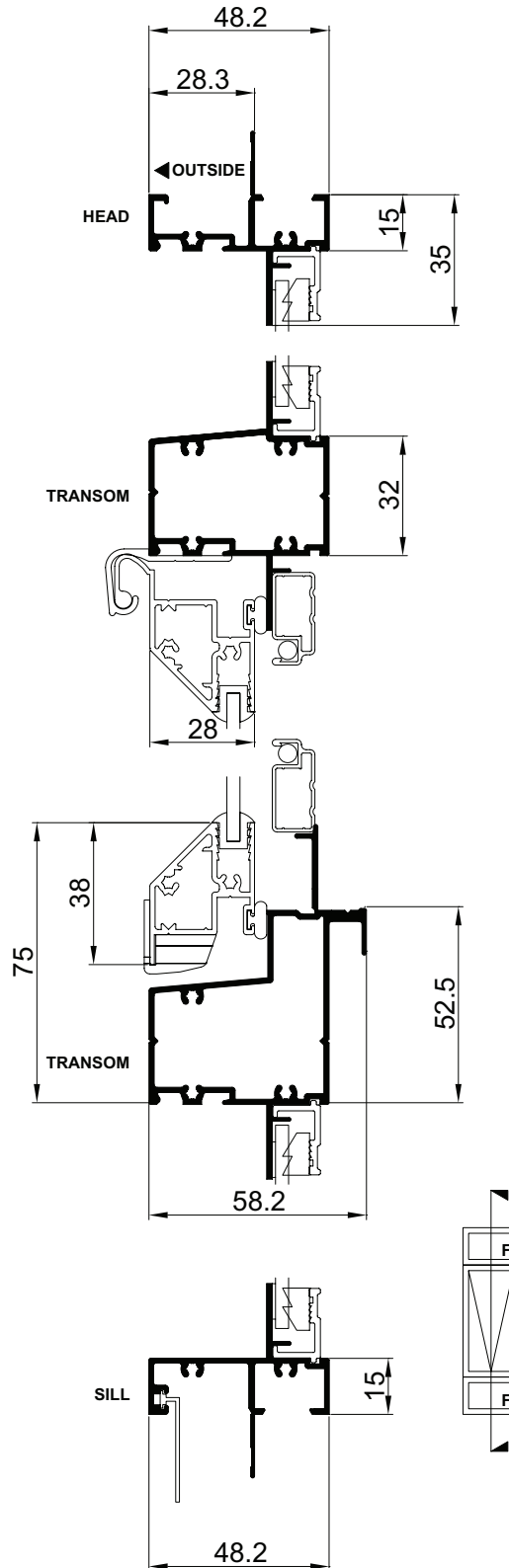

Cross Sectional Views

Synergy® Sentinel Awning Window | **Single Lite** | **VIC ONLY**

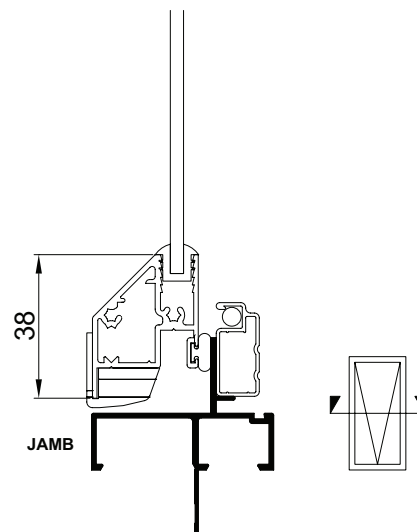
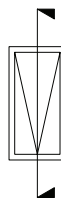
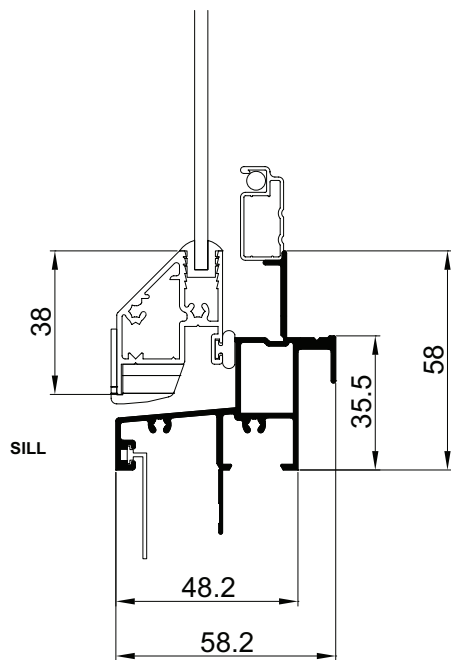
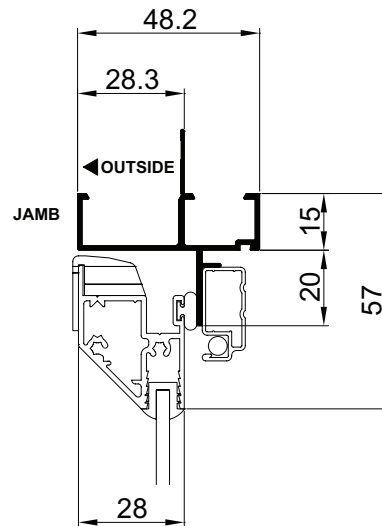
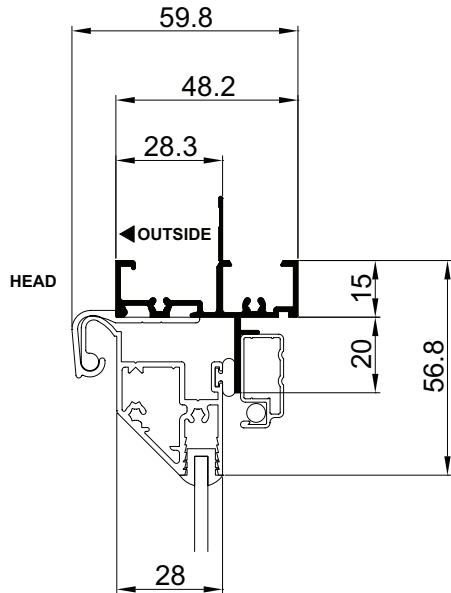

Cross Sectional Views

Synergy® Sentinel Awning Window | **Two Lite with Lowlite** | VIC ONLY

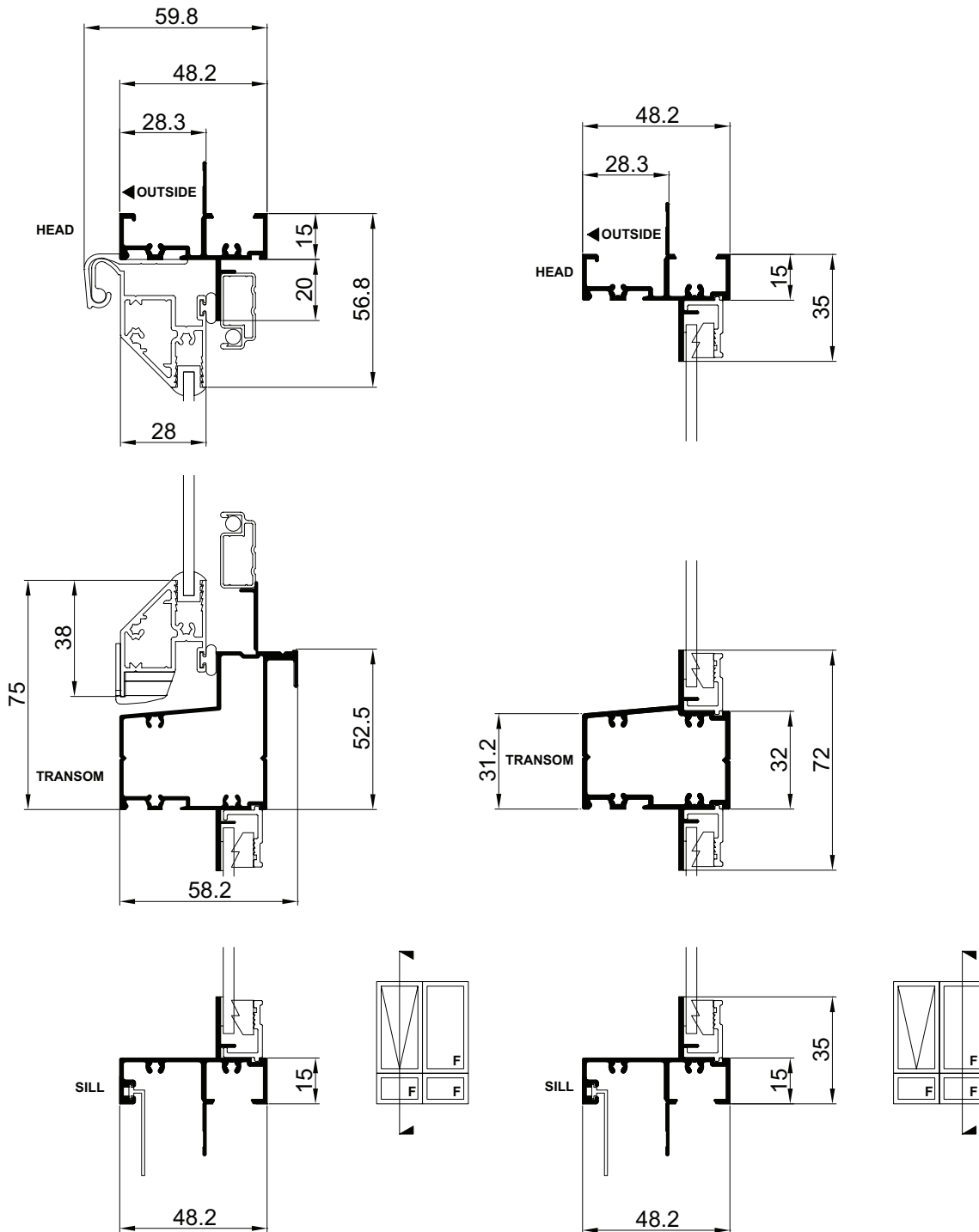

Cross Sectional Views

Synergy® Sentinel Awning Window | **Two Lite with Lowlite** | VIC ONLY

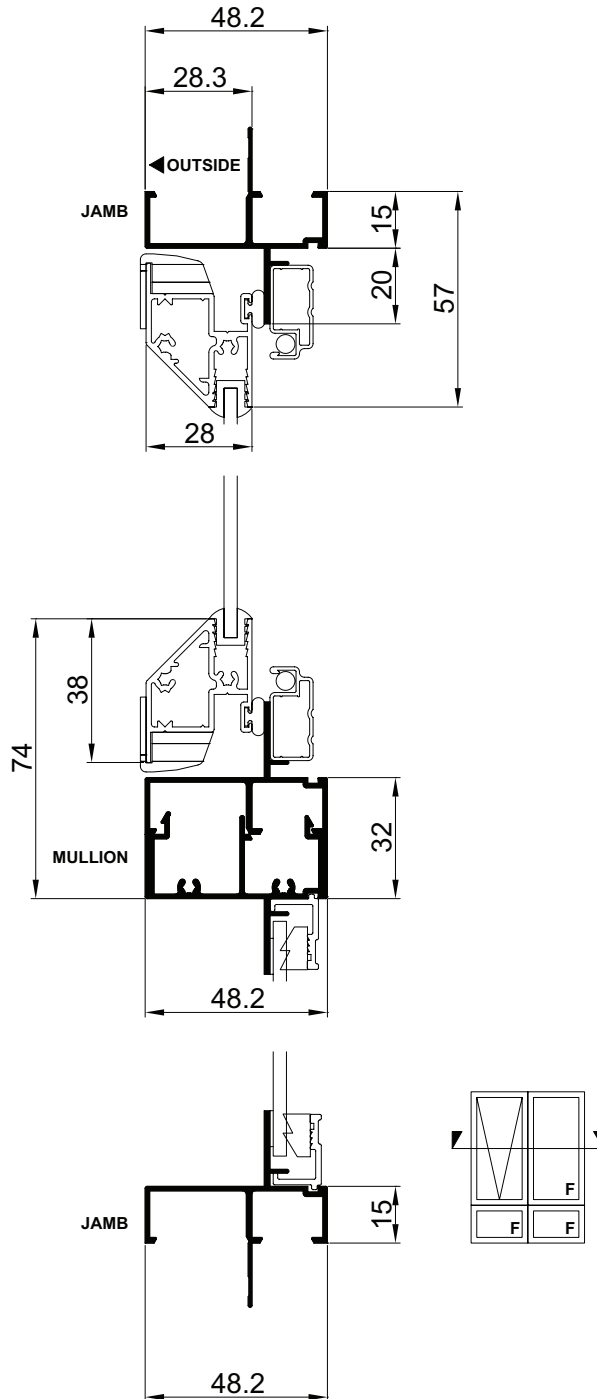

Cross Sectional Views

Synergy® Sentinel Awning Window | **Single with Hilite and Lowlite** | VIC ONLY

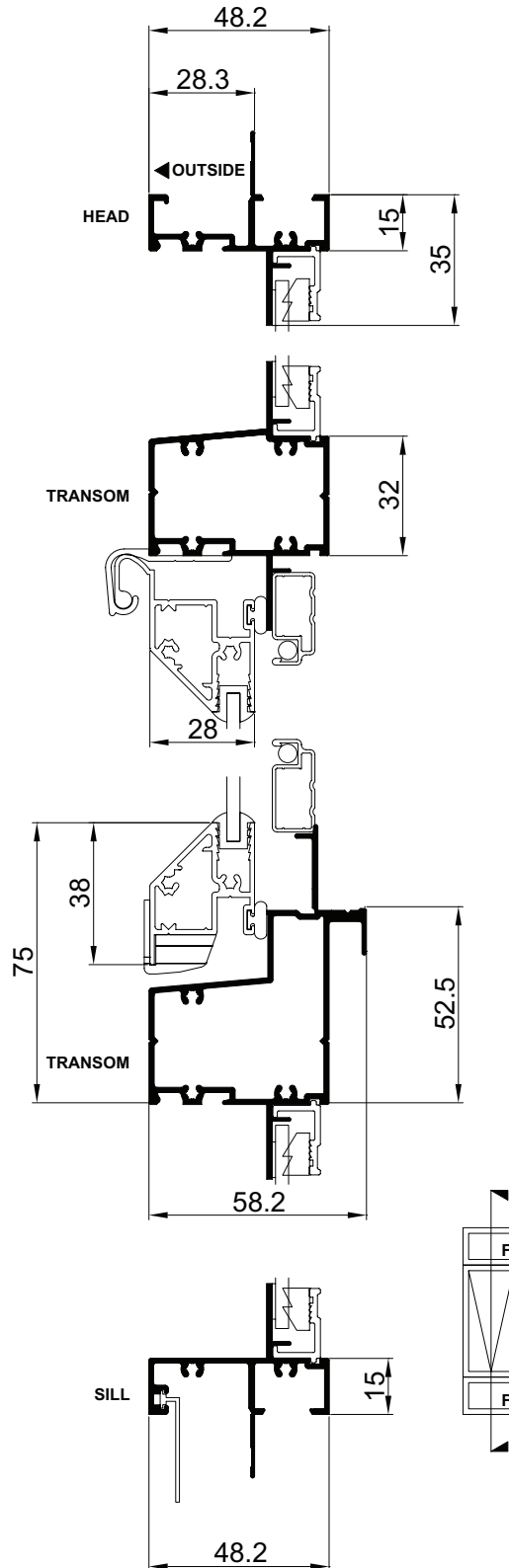

Cross Sectional Views

Synergy® Awning Window | **Double Glazed** | NSW/ACT/VIC

