



Crestlite® Viscount Sliding Doors Installation

Viscount Sliding Doors - Installation

Viscount Sliding Doors - Installation

Building In Detail | **Blockwork with Sump Sill**

Building In Detail | **Blockwork with Sub Sill**

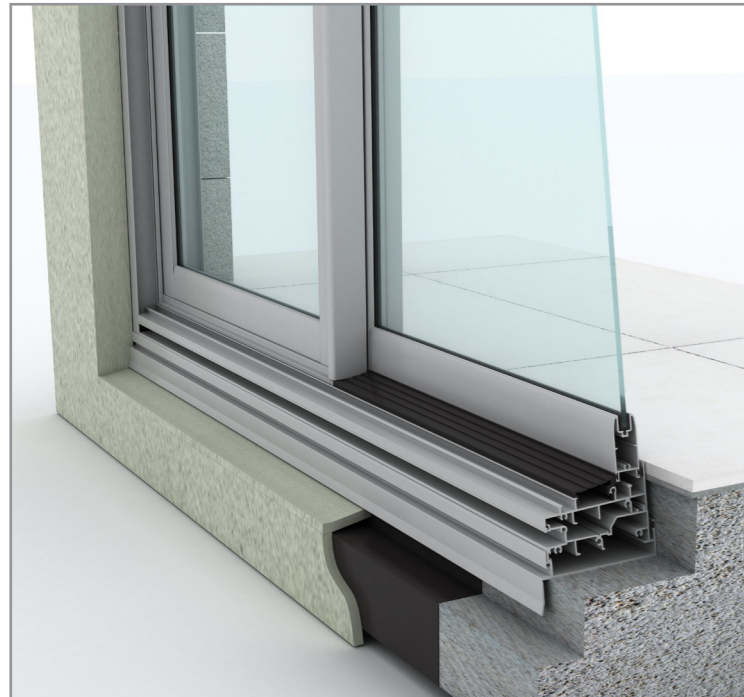

INSTALLING FRAME CORRECTLY

- Measure the frame opening to ensure that there is sufficient room for the product and additional packing.

Blockwork Opening:
Height = Frame Height + 50mm
Width = Frame Size + 20mm

- Header beam should be at least 12mm clear of window frame.
- Fit subframe to opening and seal fixings.
- Fit door to subframe (screw or pop-rivet).
- Do not permit weight of eaves or arch bars to bear on any window or door frame. **(Windows and doors are not load bearing.)**
- To ensure the satisfactory long term performance of doors, sill must be fully supported.
- Ensure outside finish does not block sill drainage holes.

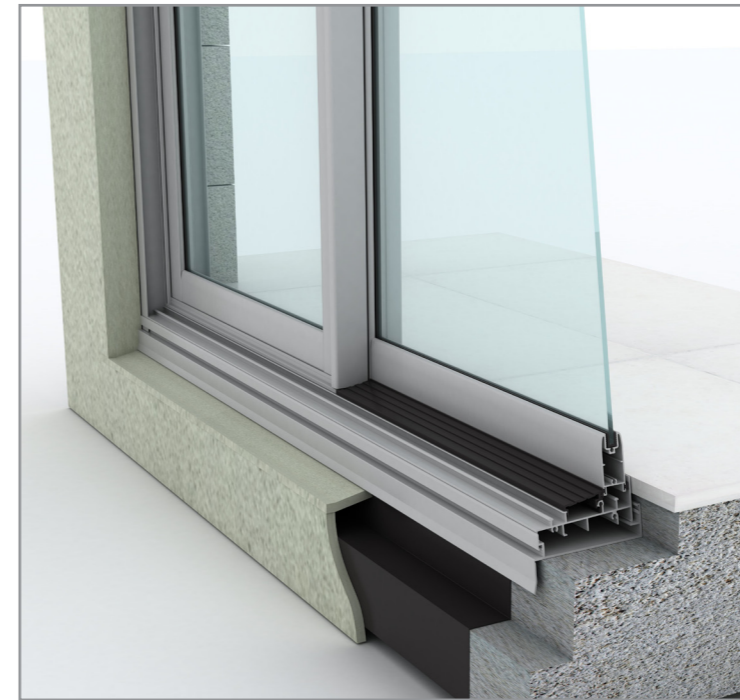

INSTALLING FRAME CORRECTLY

- Measure the frame opening to ensure that there is sufficient room for the product and additional packing.

Blockwork Opening:
Height = Frame Height + 50mm
Width = Frame Size + 20mm

- Header beam should be at least 12mm clear of window frame.
- Fit subframe to opening and seal fixings.
- Fit door to subframe (screw or pop-rivet).
- Do not permit weight of eaves or arch bars to bear on any window or door frame. **(Windows and doors are not load bearing.)**
- To ensure the satisfactory long term performance of doors, sill must be fully supported.
- Ensure outside finish does not block sill drainage holes.

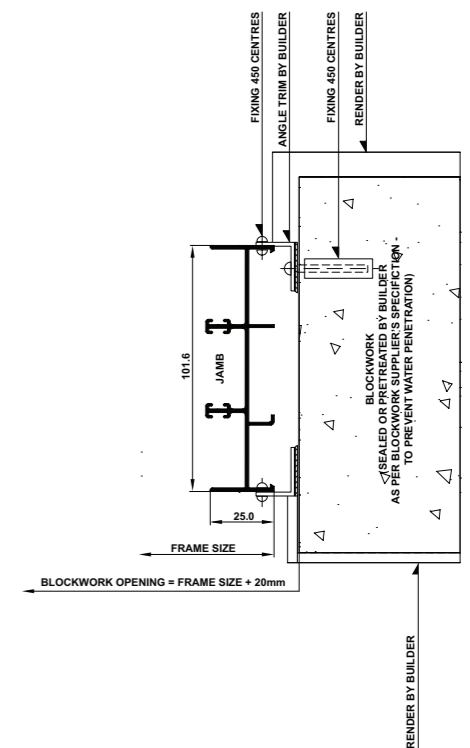
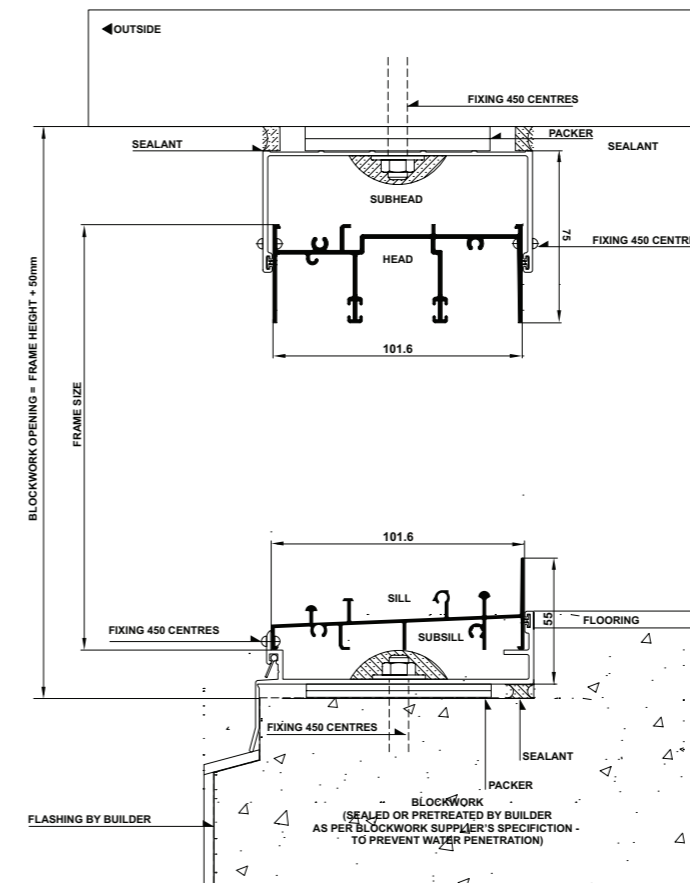
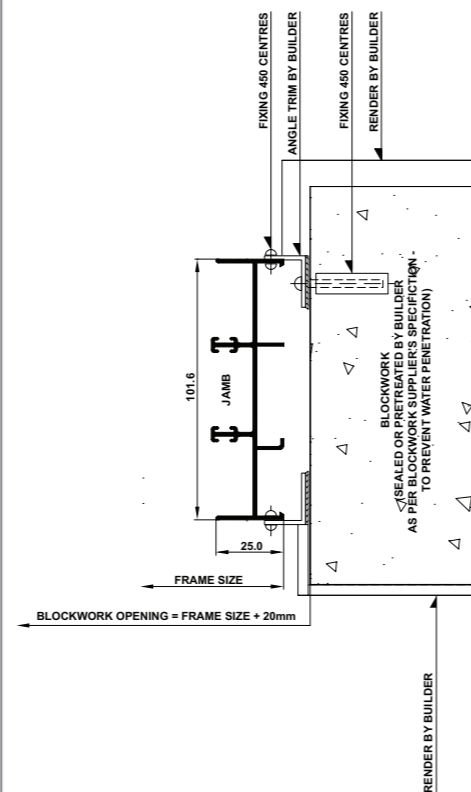
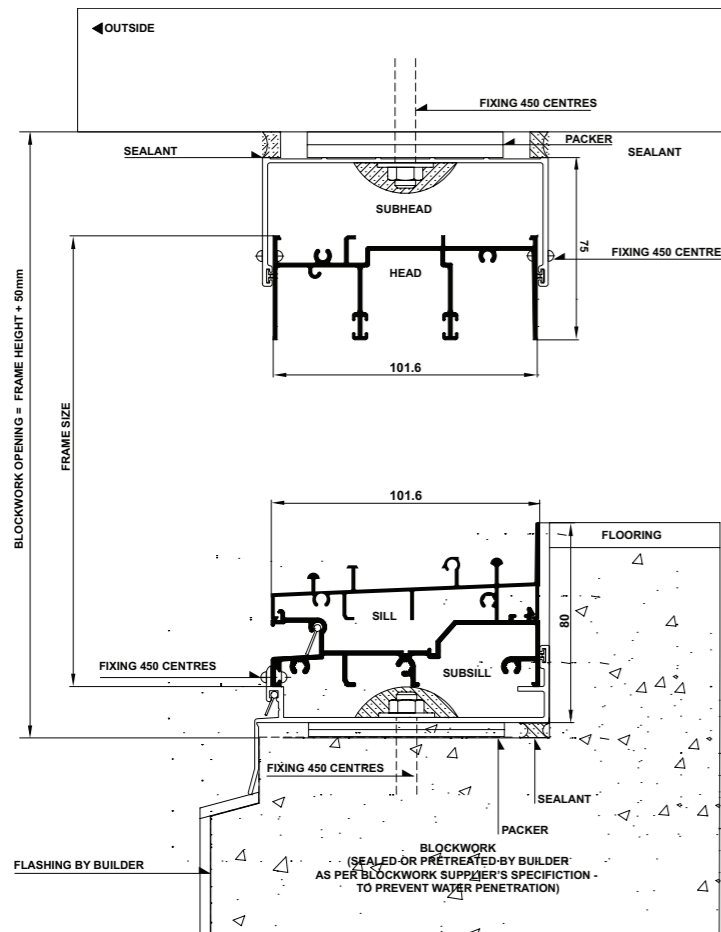



Crestlite® Viscount Sliding Doors

Cross Sectional Views

Viscount Sliding Doors - Cross Sectional Views

Viscount Sliding Doors - Cross Sectional Views

Two Lite | FX

Two Lite | FX

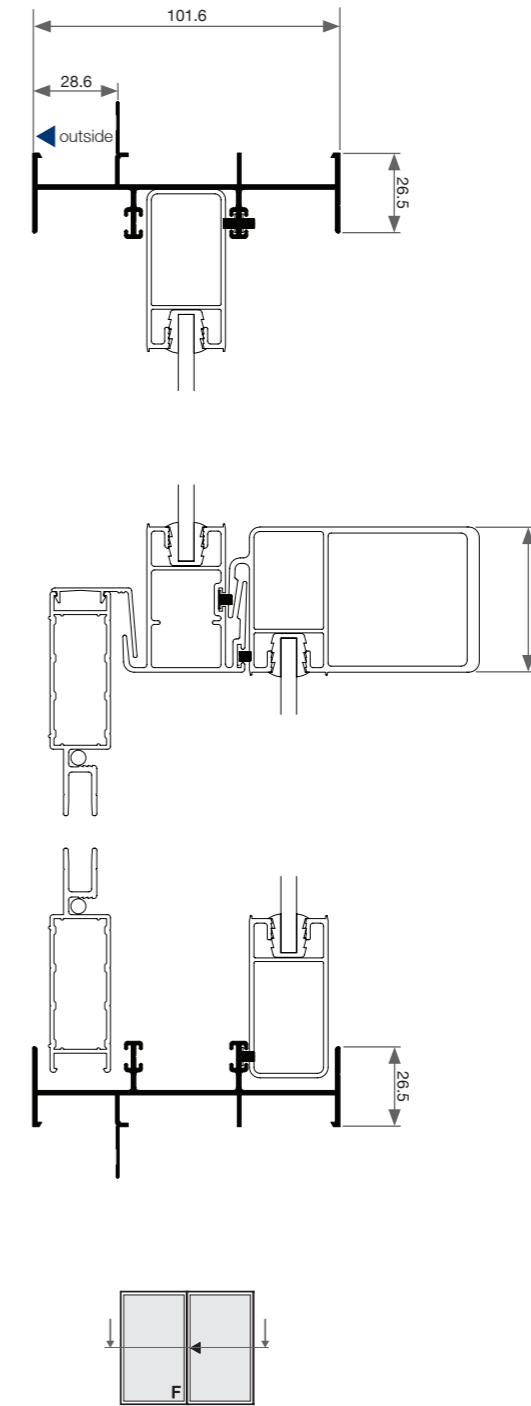
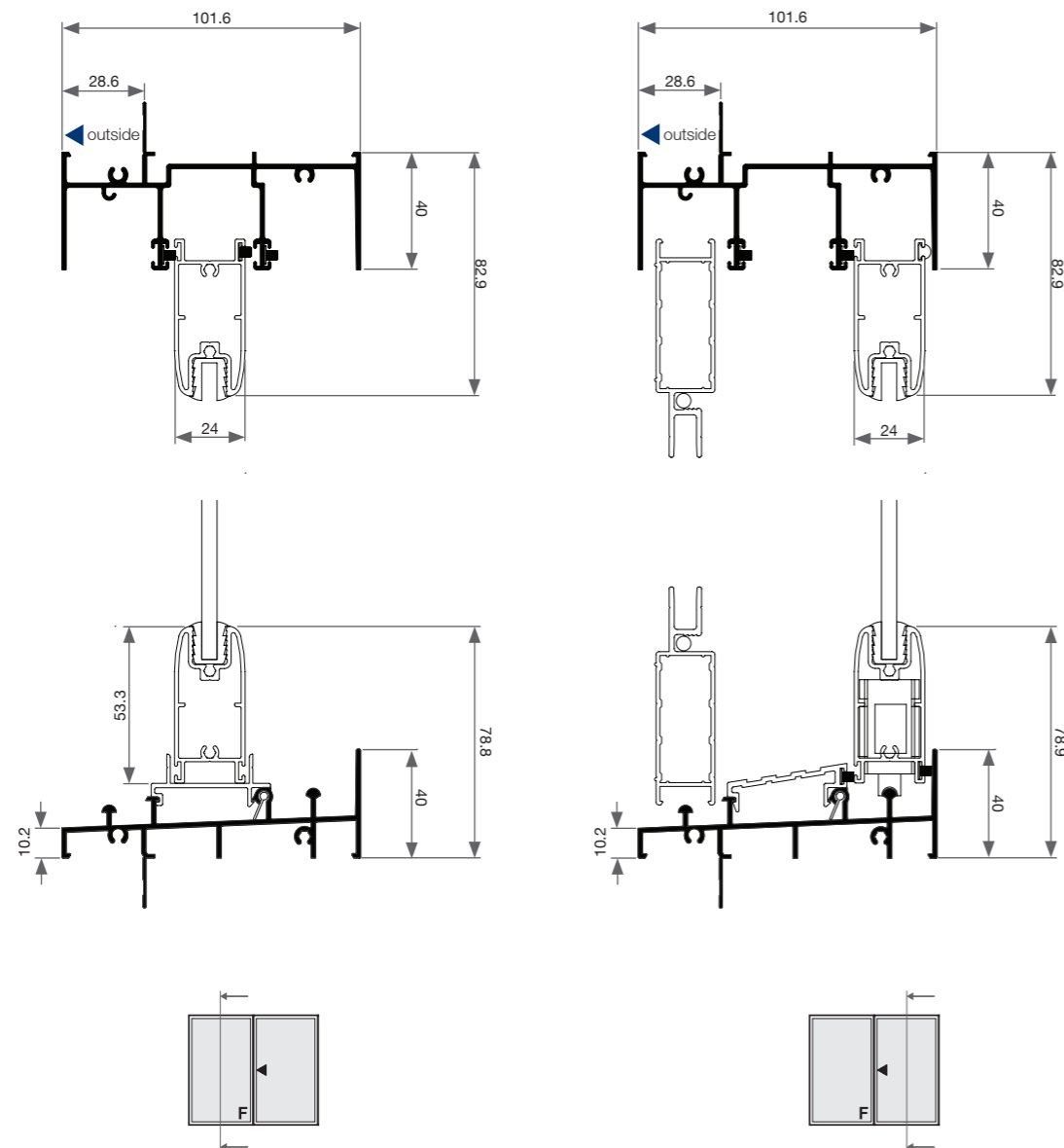

Viscount Sliding Doors - Cross Sectional Views

Viscount Sliding Doors - Cross Sectional Views

Three Lite | FXF

Three Lite | FXF

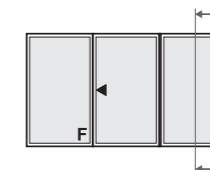
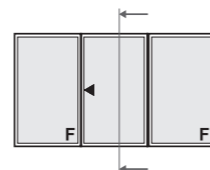
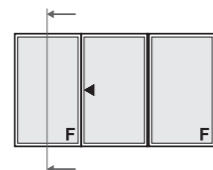
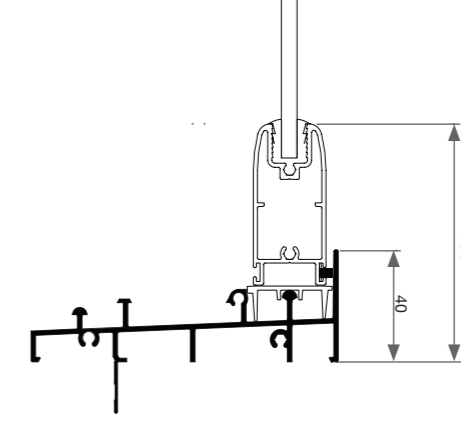
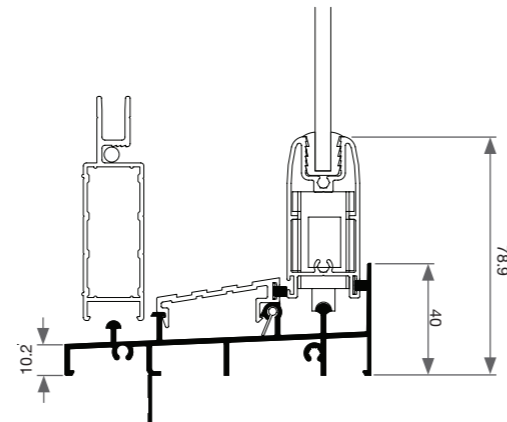
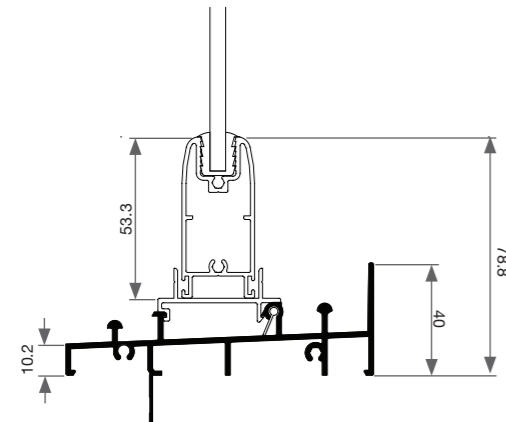
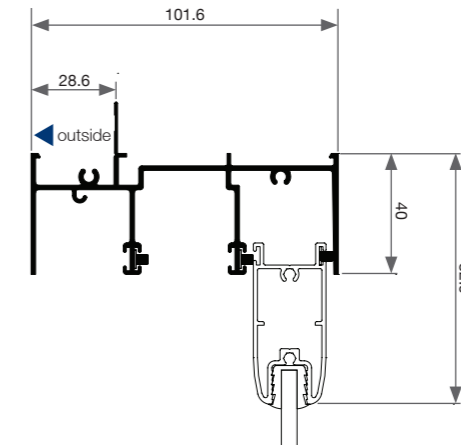
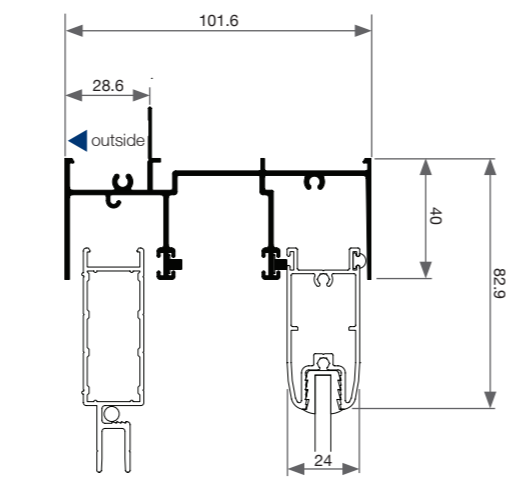
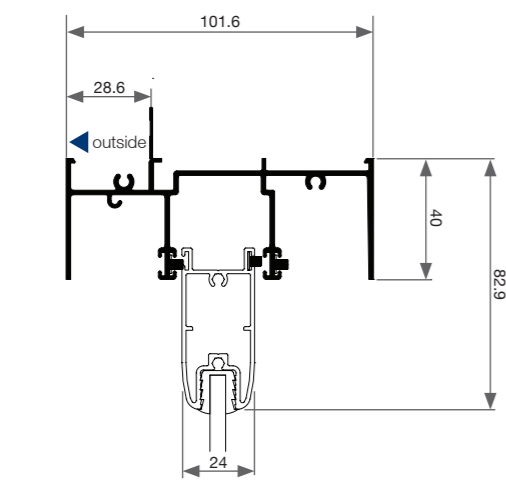

Viscount Sliding Doors - Cross Sectional Views

Viscount Sliding Doors - Cross Sectional Views

Three Lite | FXF

Four Lite | FXXF

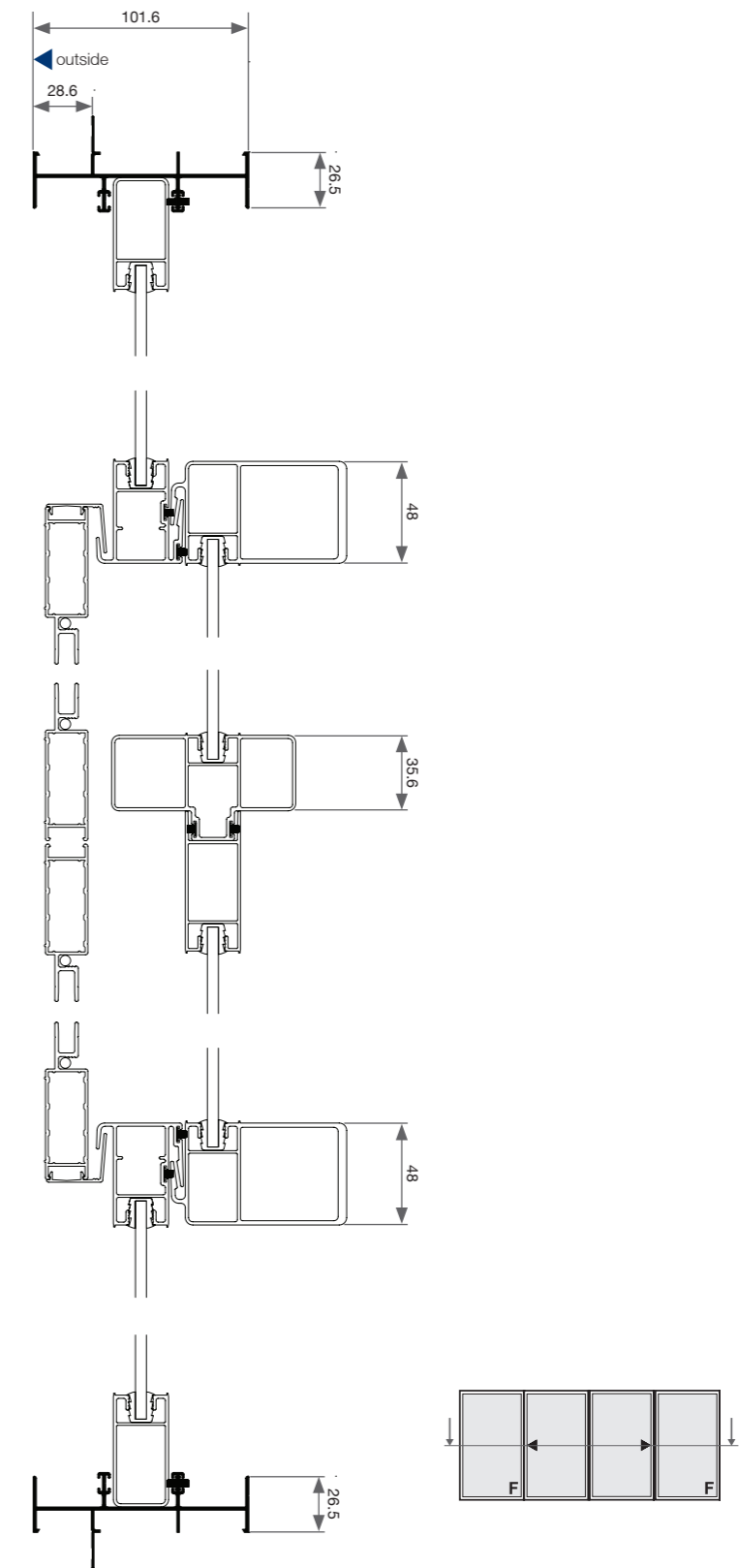
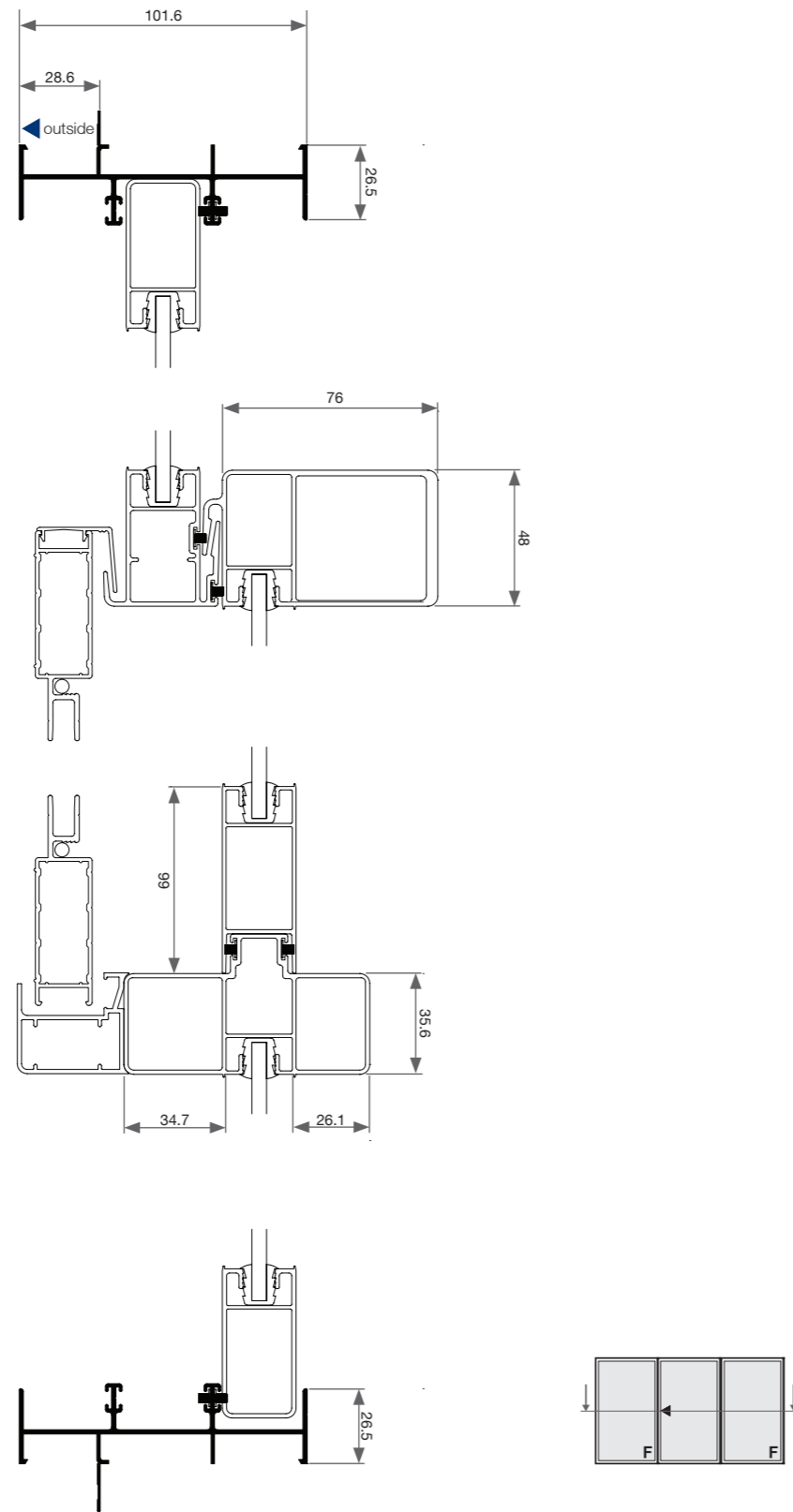

Viscount Sliding Doors - Cross Sectional Views

Viscount Sliding Doors - Cross Sectional Views

External Two Lite | FX

External Two Lite | FX

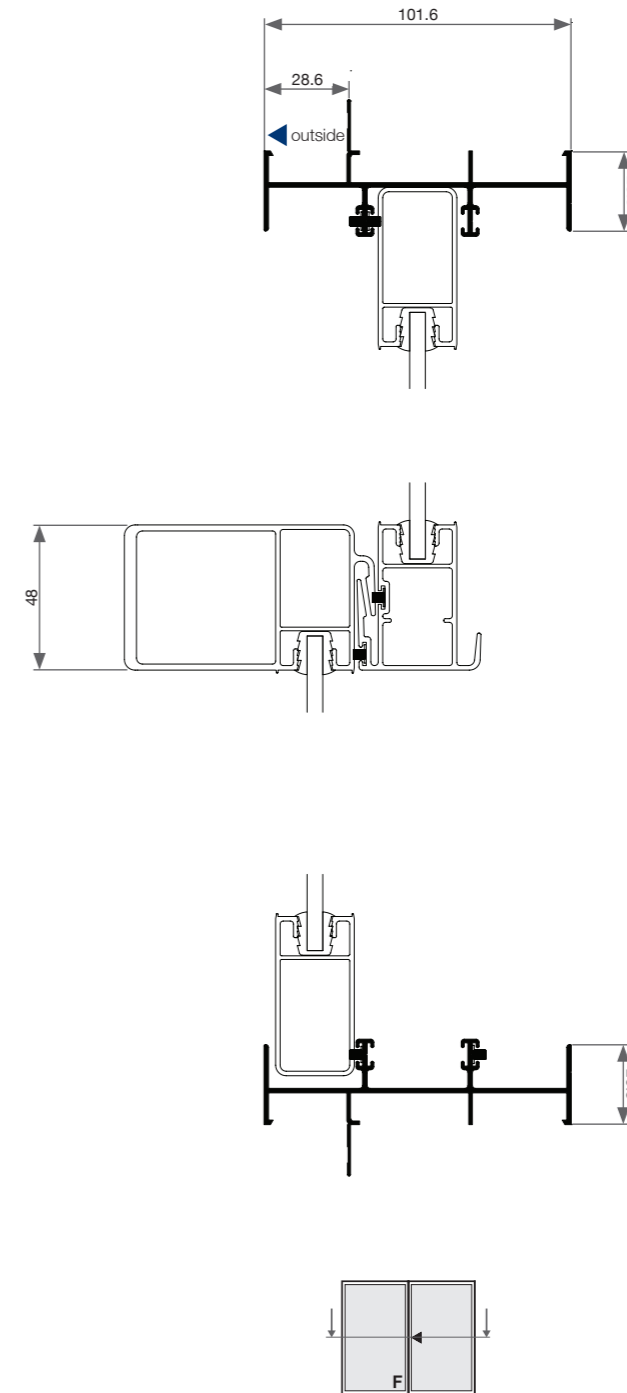
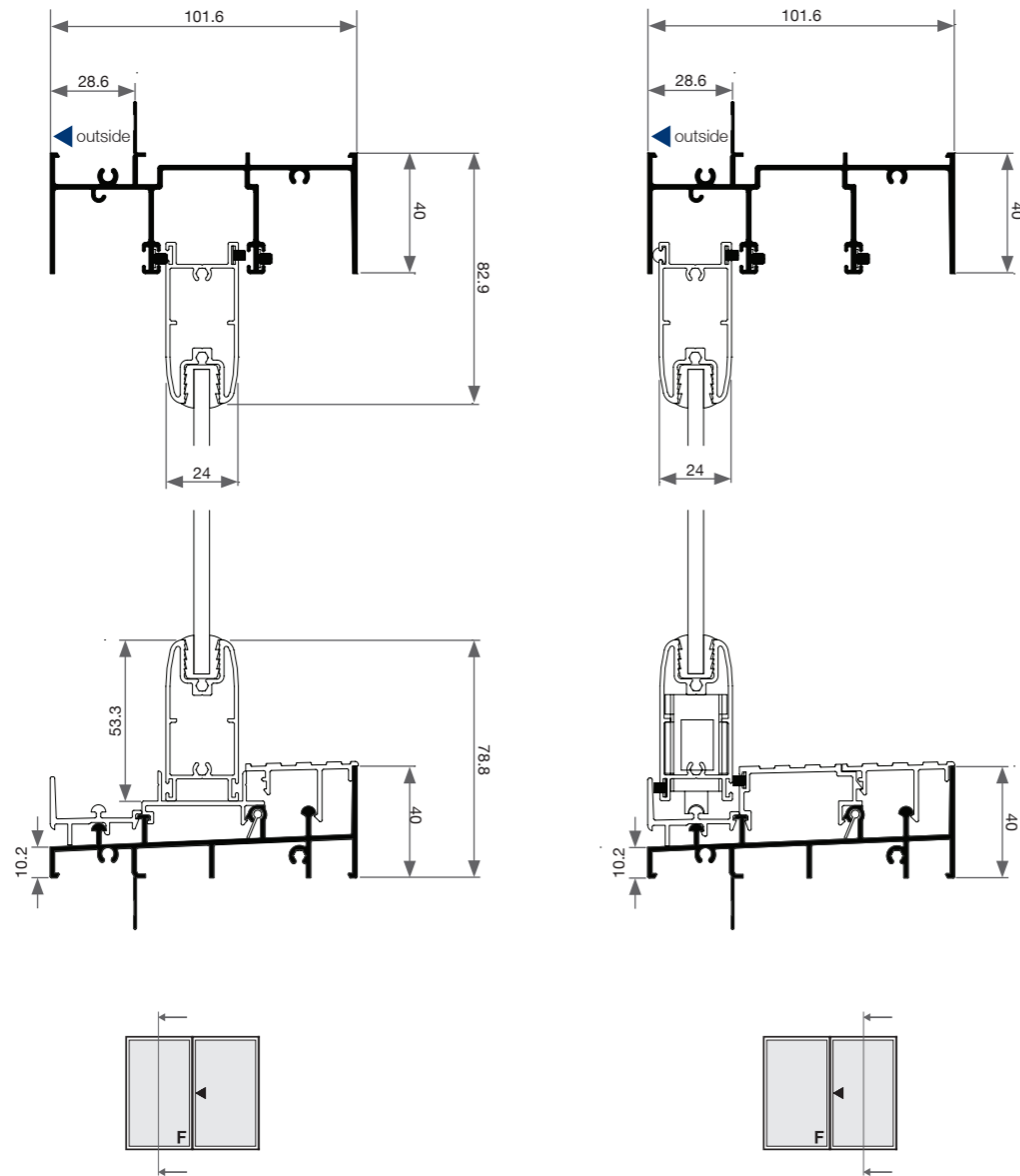

Viscount Sliding Doors - Cross Sectional Views

Viscount Sliding Doors - Cross Sectional Views

External Four Lite | FXXF

Two Lite | FX | Double Glazed

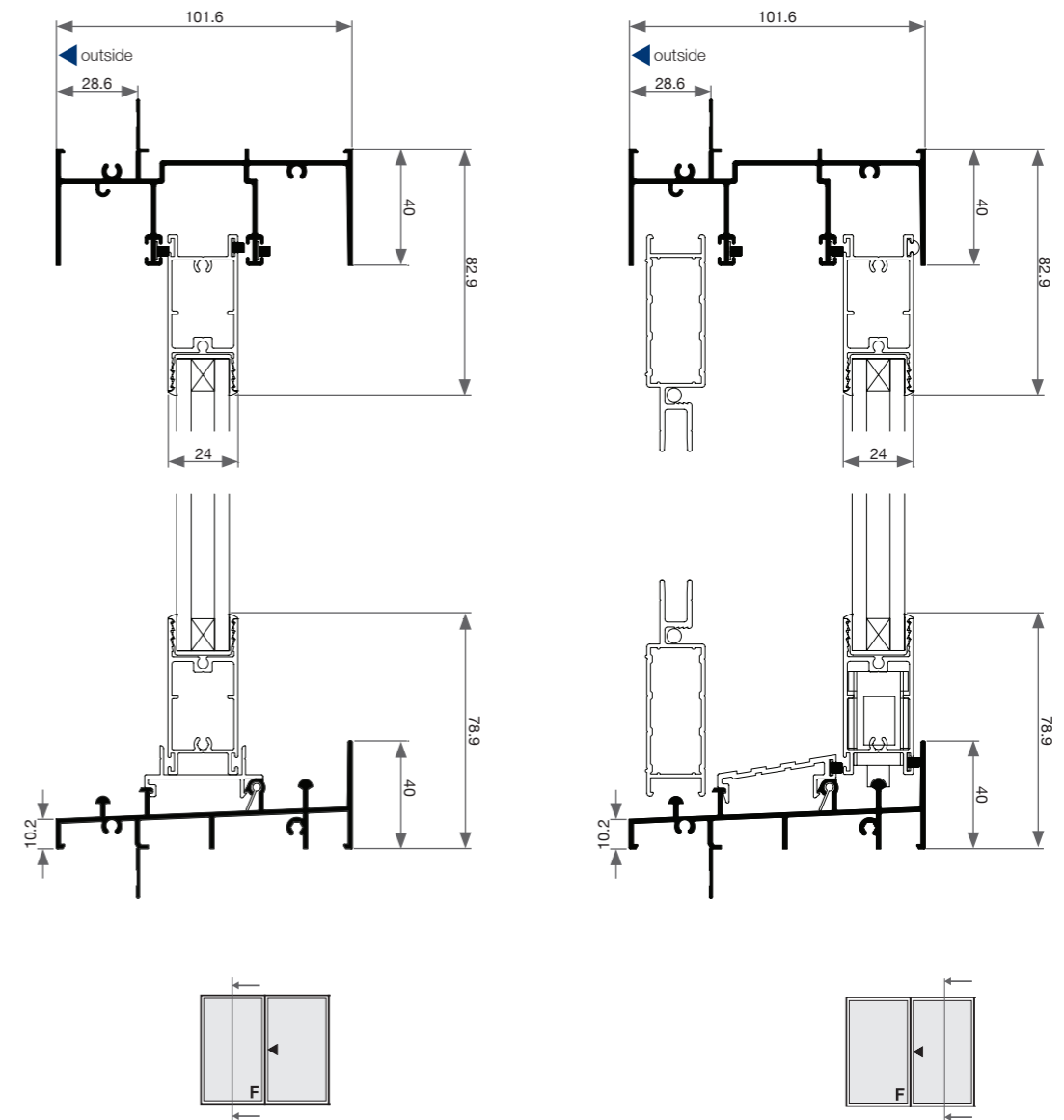
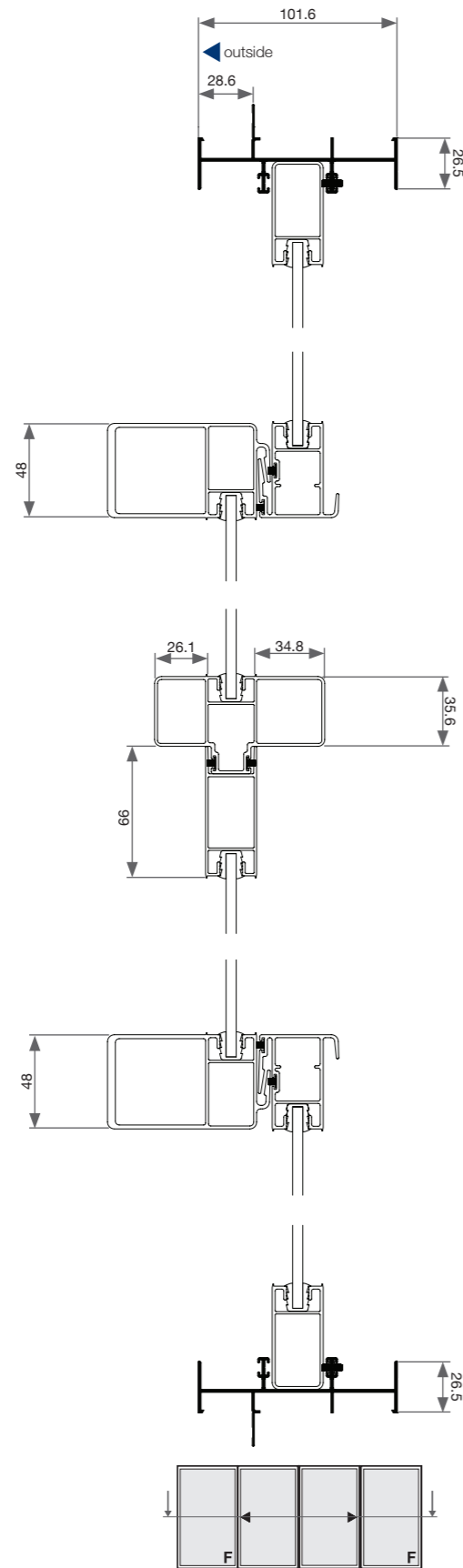

Viscount Sliding Doors - Cross Sectional Views

Two Lite | FX | Double Glazed

