

Features & Benefits

Trend® Internal Offset Framing

1. Framing

The Crestlite® Internal Offset Framing offers a commercial look for apartments, high end residential, or where ever a commercial frame is required. This robust frame allows for large fixed lite applications for greater viewing area. Overall frame width is 25mm x 102mm

Crestlite® Internal Offset Framing has been designed to have any of the Trend® or Quantum® window ranges of product inserted into the frame in either single or double glazed configurations.

2. Glazing

The Crestlite® Internal Offset Framing has a number of glazing options for energy efficiency and acoustic requirements.

Glazing is available in 5mm toughened glass through to 25mm double glazed units. Large single lite windows are available.

3. Energy Efficiency Options

Trend® Thermashield® in various glazing styles are available to help reduce energy consumption. Trend® Thermashield® eans greater control, bigger savings and most importantly one less thing to worry about.

4. Acoustic options

SoundMizer® acoustic solutions can range in various STC ratings. SoundMizer® acoustic solutions can reduce aircraft, highway traffic, railway and other annoying noise problems. For information or technical details contact Trend®.

5 Operable Windows

The Trend® Internal Offset Framing offers the ability to have operable windows inserted into the frame for greater flexibility and ventilation options.

Other Trend® or Quantum® products in various styles and openings can be inserted into the Trend® Internal Offset Framing to give a more commercial look while allowing ventilation. These include hinged doors.

6 Finishes

Powdercoated finishes are available in a range of colours and finishes. Warranty finishes are available as well as anodised options to suite most commercial applications. Decowood woodgrain finish is also available with the Trend® range.

(This may vary - for more information on variations to this please contact you Trend Sales Executive)

Glazing is all done internally

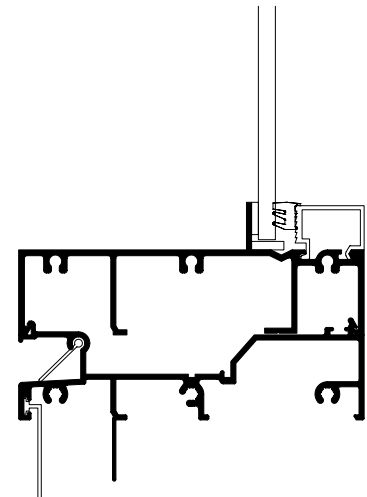
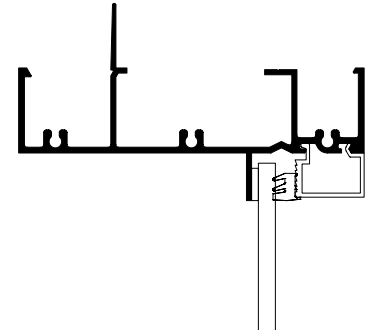

Please note that drawings are not to scale

Trend® Internal Offset Framing | A-CR-OF | Mk-4 | 1 Jul 2009

Confidentiality Notice: This document and the information it contains are copyright and confidential to Trend® Windows & Doors Pty Limited. Disclosure, use and copying in any form whatsoever, except as authorised by Trend® Windows & Doors in writing, are strictly prohibited. Patents and Design Registrations pending.

Size Range

Trend[®] Internal Offset Framing

Contact Trend[®] for further information

Please note that drawings are not to scale

Trend[®] Internal Offset Framing | A-CR-OF | Mk-4 | 1 Jul 2009

Confidentiality Notice: This document and the information it contains are copyright and confidential to Trend[®] Windows & Doors Pty Limited. Disclosure, use and copying in any form whatsoever, except as authorised by Trend[®] Windows & Doors in writing, are strictly prohibited. Patents and Design Registrations pending.

Ordering Details

Trend® Internal Offset Framing

Contact Trend® for further information

Please note that drawings are not to scale

Trend® Internal Offset Framing | A-CR-OF | Mk-4 | 1 Jul 2009

Confidentiality Notice: This document and the information it contains are copyright and confidential to Trend® Windows & Doors Pty Limited. Disclosure, use and copying in any form whatsoever, except as authorised by Trend® Windows & Doors in writing, are strictly prohibited. Patents and Design Registrations pending.

Installation

Trend® Internal Offset Framing | Building In Detail | **Brick Veneer - 230mm wall**

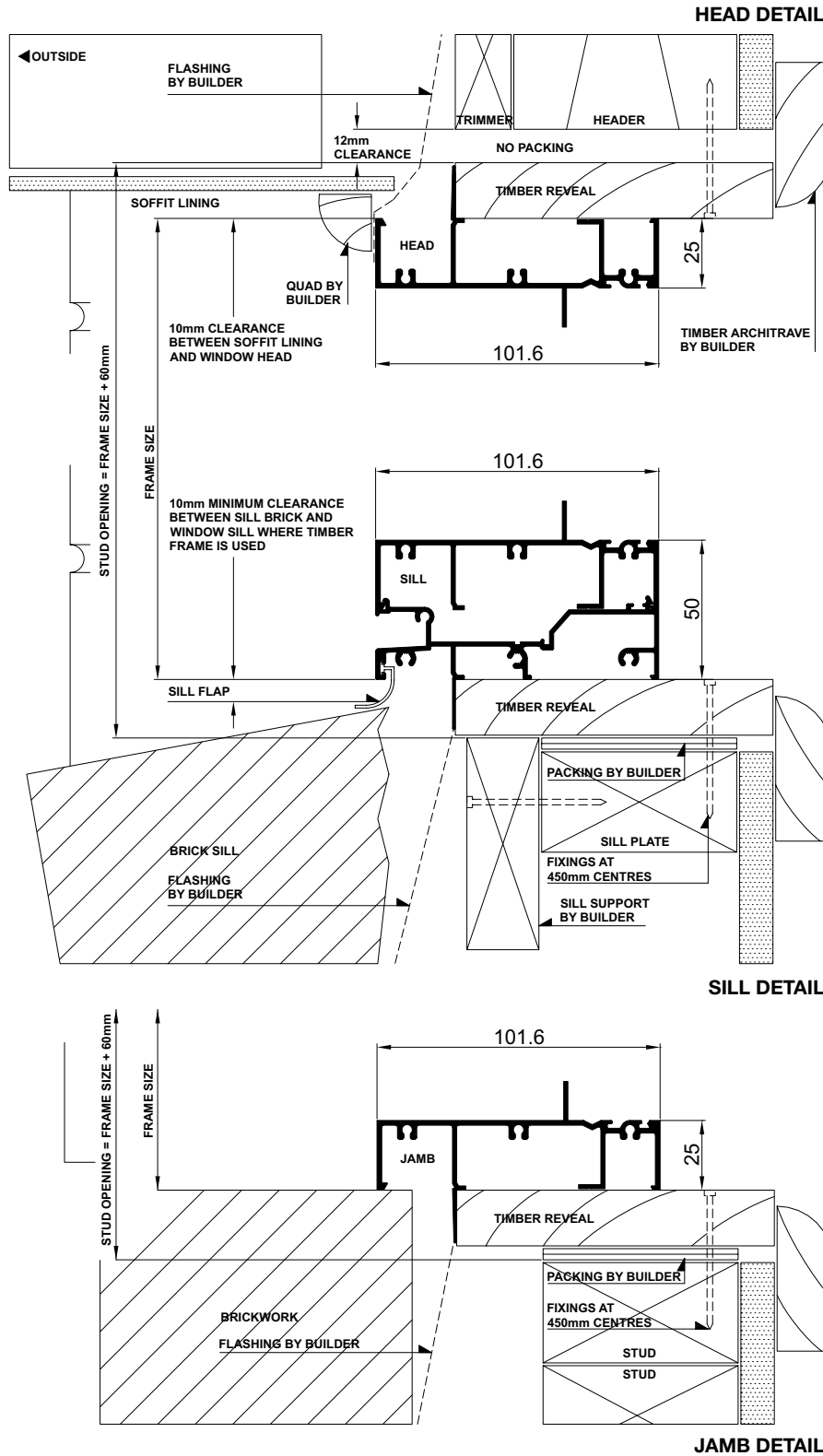

Please note that drawings are not to scale

Trend® Internal Offset Framing | A-CR-OF | Mk-4 | 1 Jul 2009

Confidentiality Notice: This document and the information it contains are copyright and confidential to Trend® Windows & Doors Pty Limited. Disclosure, use and copying in any form whatsoever, except as authorised by Trend® Windows & Doors in writing, are strictly prohibited. Patents and Design Registrations pending.

Installation

Trend® Internal Offset Framing | Building In Detail | **Double Brick - 280mm wall**

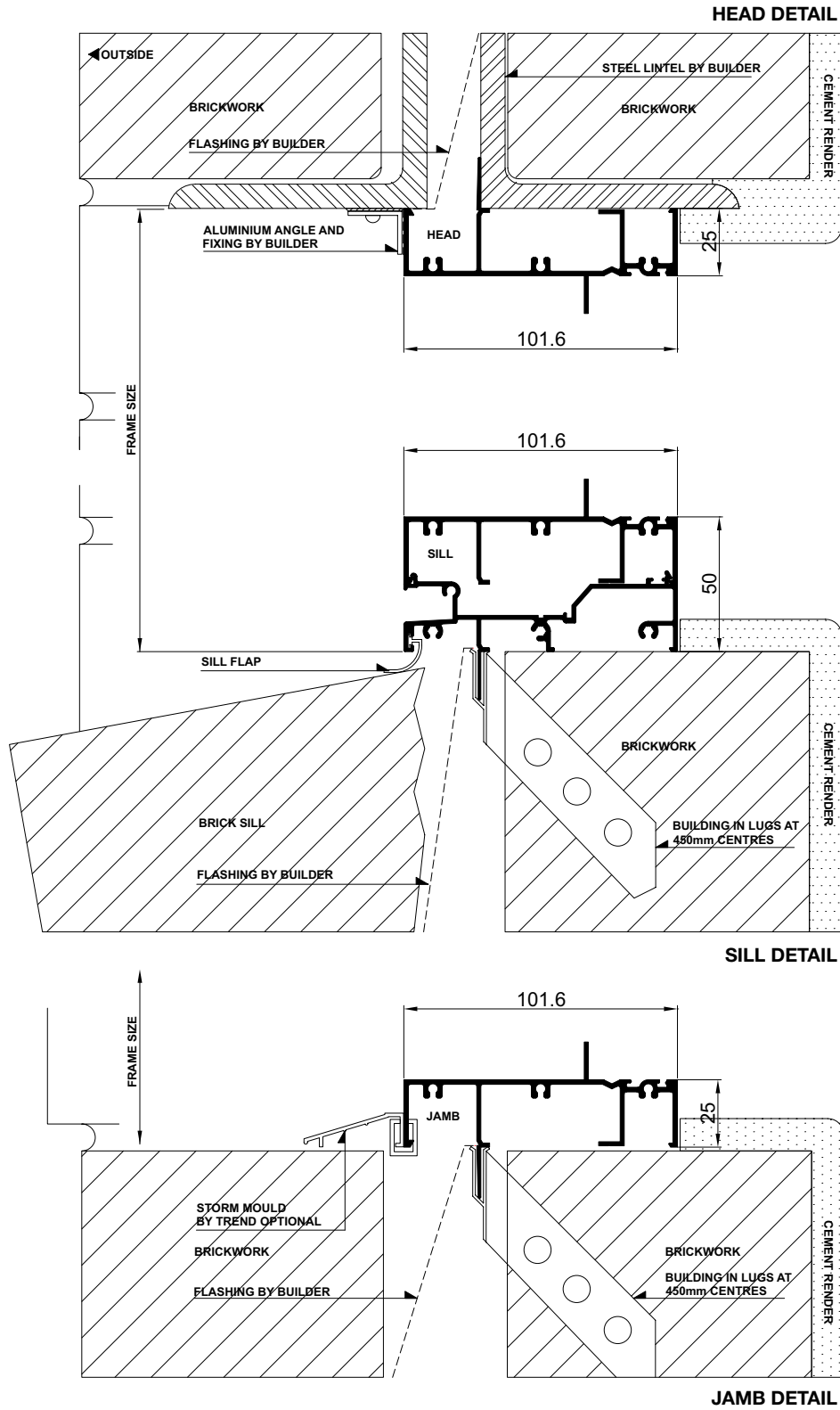

Please note that drawings are not to scale

Trend® Internal Offset Framing | A-CR-OF | Mk-4 | 1 Jul 2009

Confidentiality Notice: This document and the information it contains are copyright and confidential to Trend® Windows & Doors Pty Limited. Disclosure, use and copying in any form whatsoever, except as authorised by Trend® Windows & Doors in writing, are strictly prohibited. Patents and Design Registrations pending.

Installation

Trend® Internal Offset Framing | Building In Detail | **Aluminium Cladding on Studs**

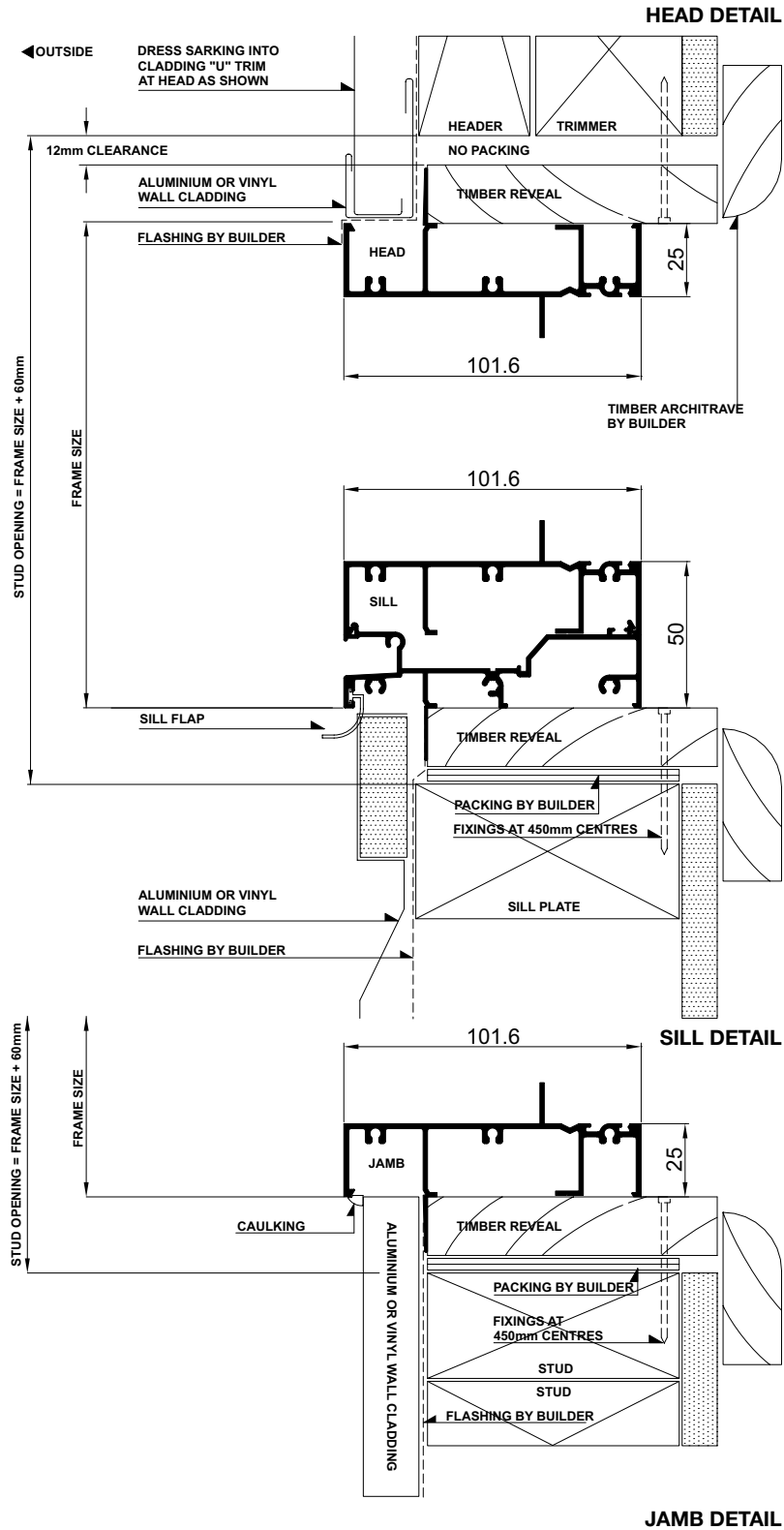

Please note that drawings are not to scale

Trend® Internal Offset Framing | A-CR-OF | Mk-4 | 1 Jul 2009

Confidentiality Notice: This document and the information it contains are copyright and confidential to Trend® Windows & Doors Pty Limited. Disclosure, use and copying in any form whatsoever, except as authorised by Trend® Windows & Doors in writing, are strictly prohibited. Patents and Design Registrations pending.

Cross Sectional Views

Trend® Internal Offset Framing | **Two Lite**

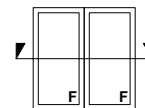
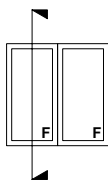
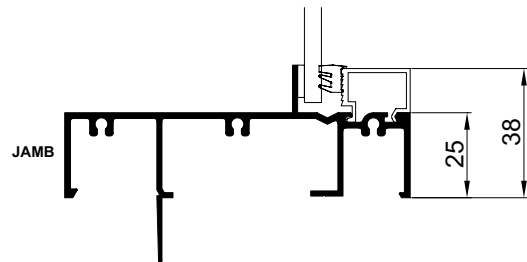
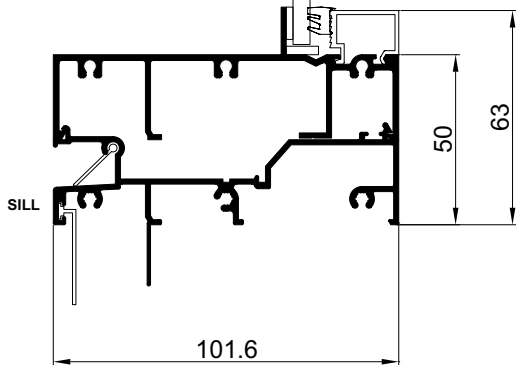
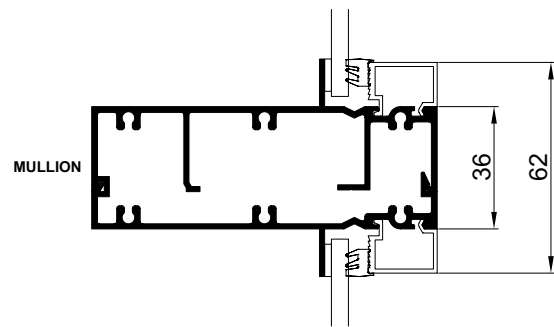
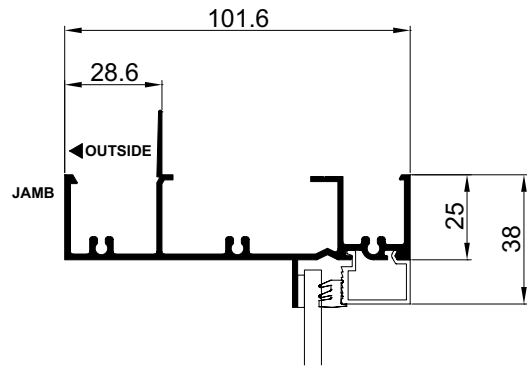
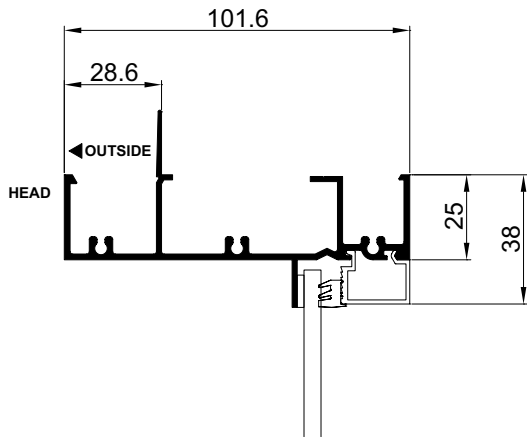

Please note that drawings are not to scale

Trend® Internal Offset Framing | A-CR-OF | Mk-4 | 1 Jul 2009

Confidentiality Notice: This document and the information it contains are copyright and confidential to Trend® Windows & Doors Pty Limited. Disclosure, use and copying in any form whatsoever, except as authorised by Trend® Windows & Doors in writing, are strictly prohibited. Patents and Design Registrations pending.

Cross Sectional Views

Trend® Internal Offset Framing | Trend® Awning Sash Insert

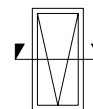
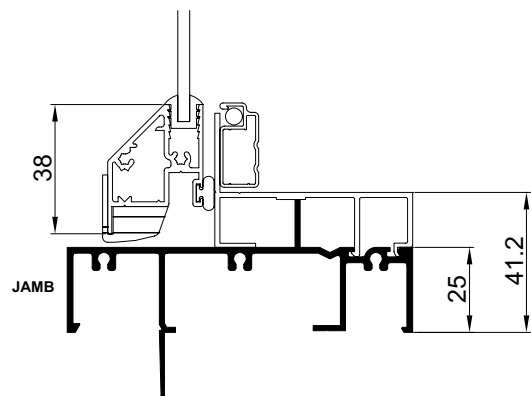
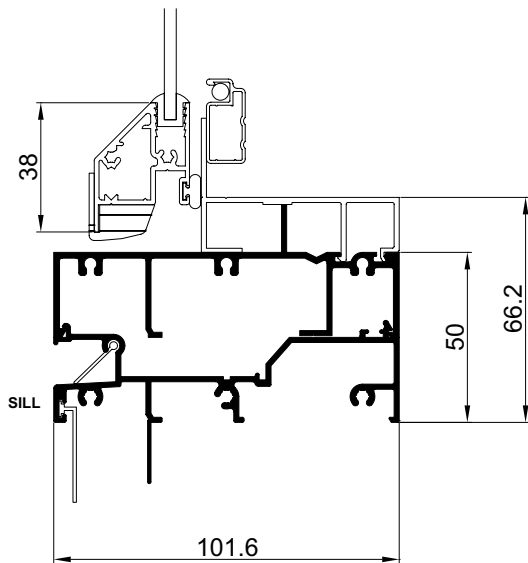
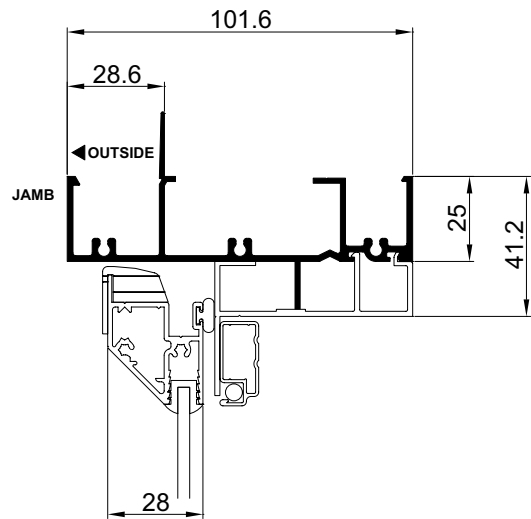
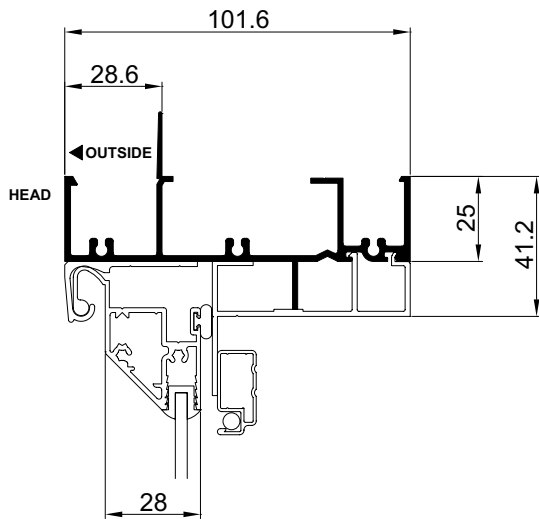

Please note that drawings are not to scale

Trend® Internal Offset Framing | A-CR-OF | Mk-4 | 1 Jul 2009

Confidentiality Notice: This document and the information it contains are copyright and confidential to Trend® Windows & Doors Pty Limited. Disclosure, use and copying in any form whatsoever, except as authorised by Trend® Windows & Doors in writing, are strictly prohibited. Patents and Design Registrations pending.

Cross Sectional Views

Trend® Internal Offset Framing | **Quantum® Awning Sash Insert**

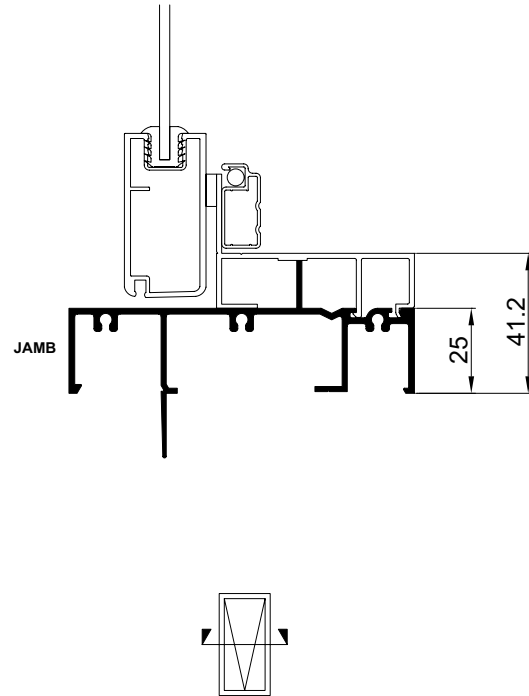
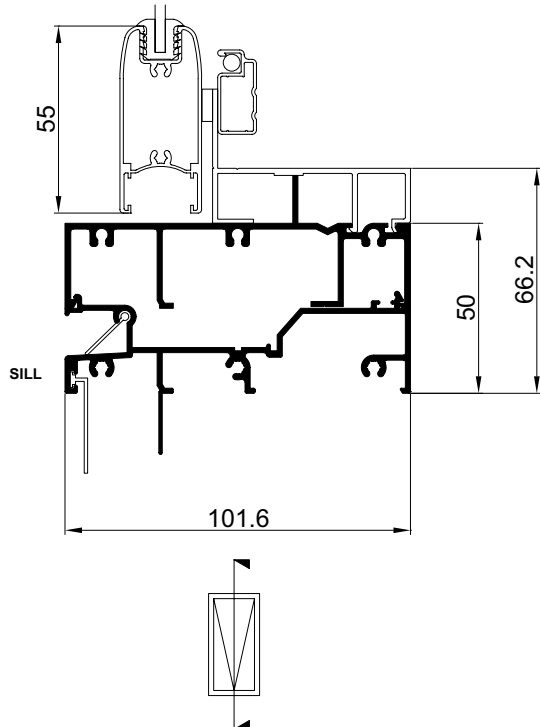
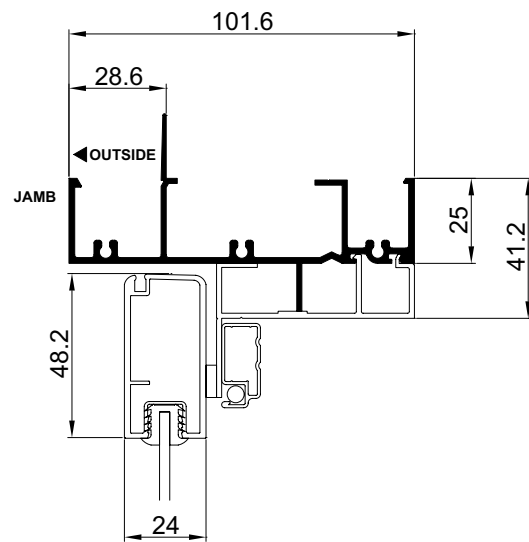
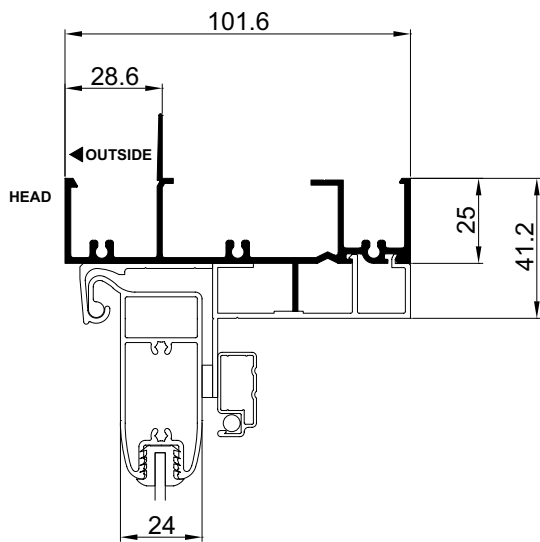

Please note that drawings are not to scale

Trend® Internal Offset Framing | A-CR-OF | Mk-4 | 1 Jul 2009

Confidentiality Notice: This document and the information it contains are copyright and confidential to Trend® Windows & Doors Pty Limited. Disclosure, use and copying in any form whatsoever, except as authorised by Trend® Windows & Doors in writing, are strictly prohibited. Patents and Design Registrations pending.

Cross Sectional Views

Trend® Internal Offset Framing | Trend® Sliding Window

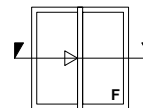
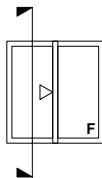
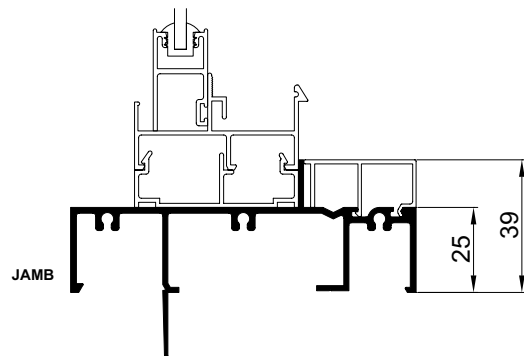
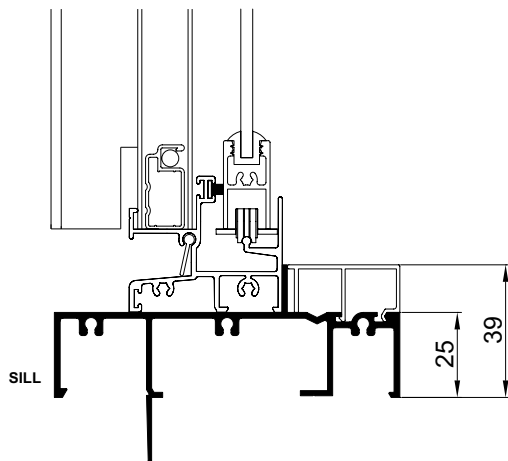
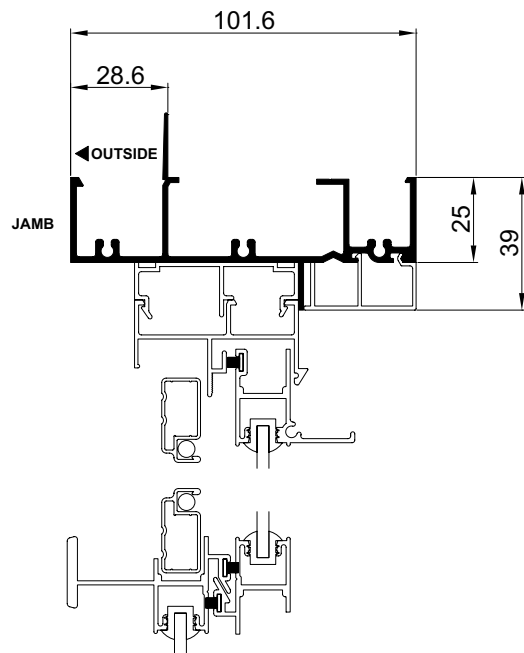
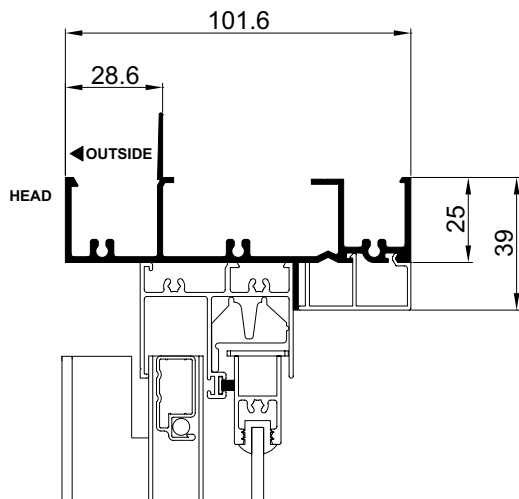

Please note that drawings are not to scale

Trend® Internal Offset Framing | A-CR-OF | Mk-4 | 1 Jul 2009

Confidentiality Notice: This document and the information it contains are copyright and confidential to Trend® Windows & Doors Pty Limited. Disclosure, use and copying in any form whatsoever, except as authorised by Trend® Windows & Doors in writing, are strictly prohibited. Patents and Design Registrations pending.

Cross Sectional Views

Trend[®] Internal Offset Framing | Trend[®] Double Hung Window Insert

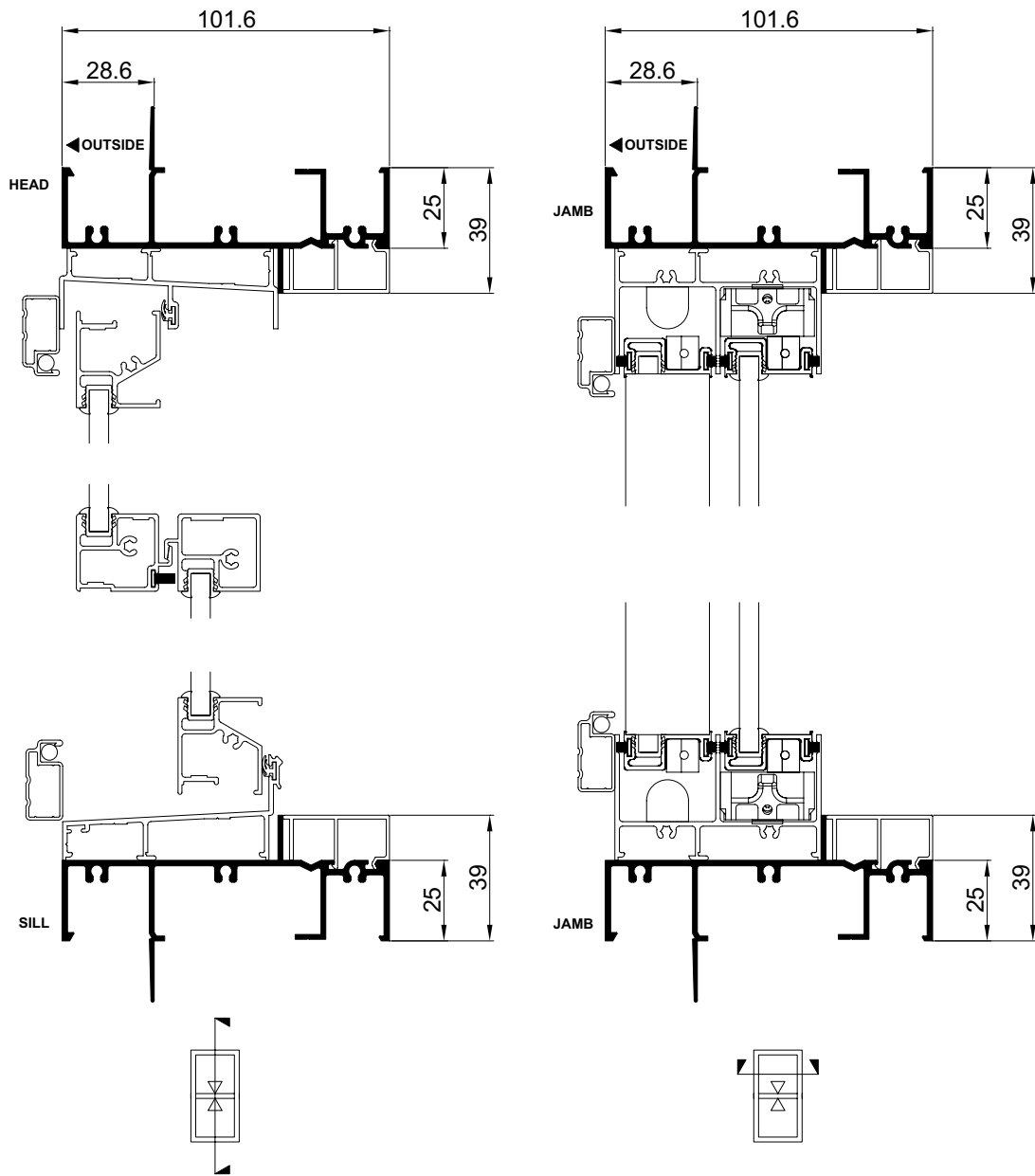

Please note that drawings are not to scale

Trend[®] Internal Offset Framing | A-CR-OF | Mk-4 | 1 Jul 2009

Confidentiality Notice: This document and the information it contains are copyright and confidential to Trend[®] Windows & Doors Pty Limited. Disclosure, use and copying in any form whatsoever, except as authorised by Trend[®] Windows & Doors in writing, are strictly prohibited. Patents and Design Registrations pending.

Cross Sectional Views

Trend® Internal Offset Framing | **Quantum® Casement Window Insert**



Please note that drawings are not to scale

Trend® Internal Offset Framing | A-CR-OF | Mk-4 | 1 Jul 2009

Confidentiality Notice: This document and the information it contains are copyright and confidential to Trend® Windows & Doors Pty Limited. Disclosure, use and copying in any form whatsoever, except as authorised by Trend® Windows & Doors in writing, are strictly prohibited. Patents and Design Registrations pending.

Cross Sectional Views

Trend® Internal Offset Framing | Quantum® Sliding Window Insert

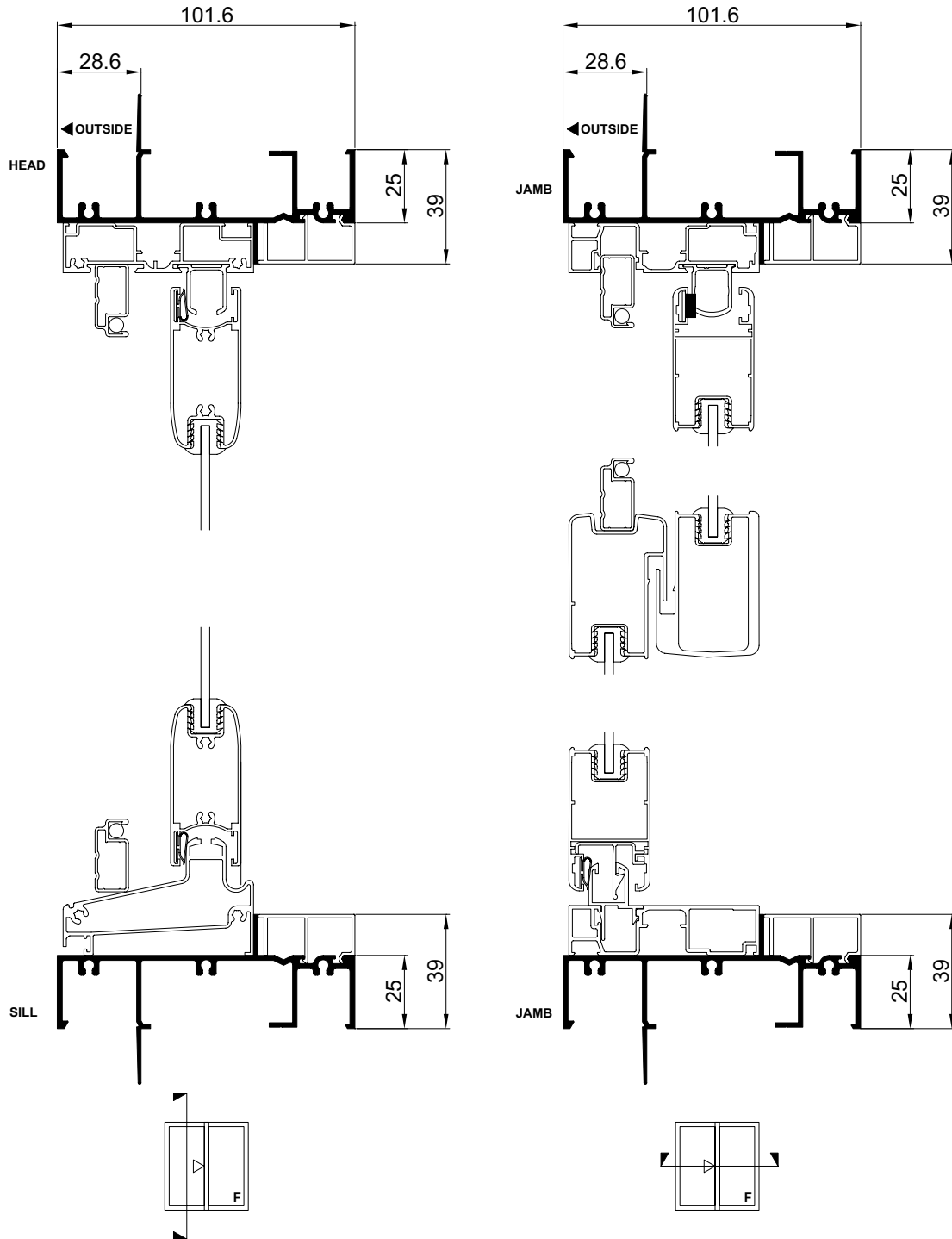

Please note that drawings are not to scale

Trend® Internal Offset Framing | A-CR-OF | Mk-4 | 1 Jul 2009

Confidentiality Notice: This document and the information it contains are copyright and confidential to Trend® Windows & Doors Pty Limited. Disclosure, use and copying in any form whatsoever, except as authorised by Trend® Windows & Doors in writing, are strictly prohibited. Patents and Design Registrations pending.

Cross Sectional Views

Trend® Internal Offset Framing | Aluminium Provincial Hinge Door Insert (Open Out)

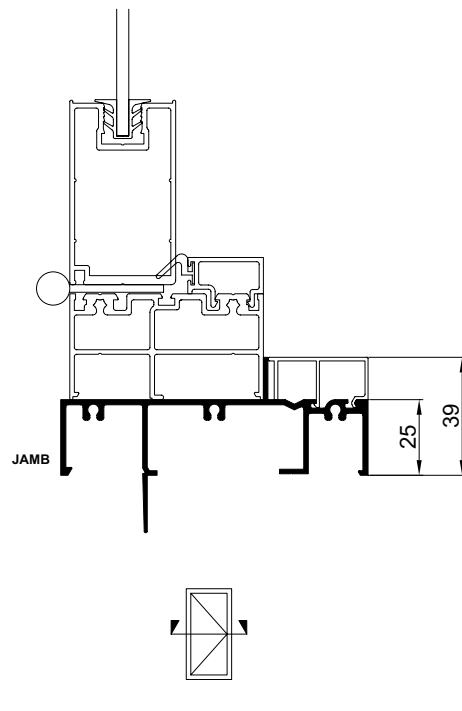
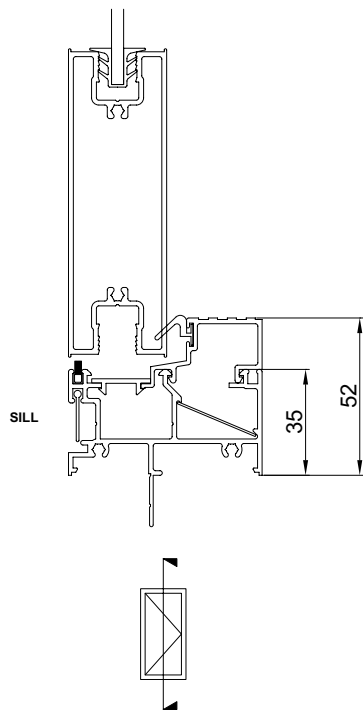
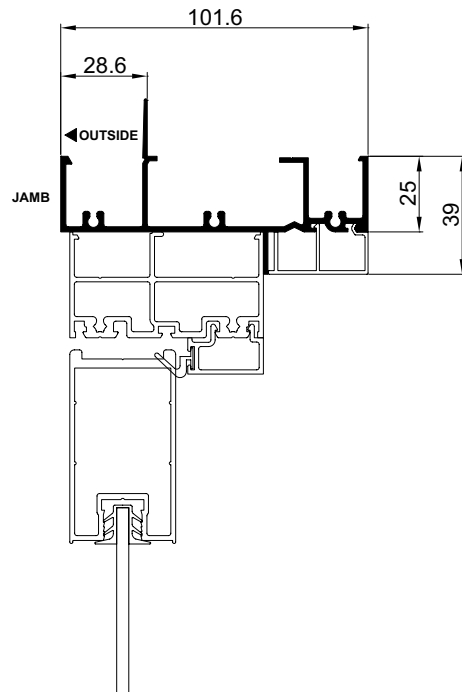
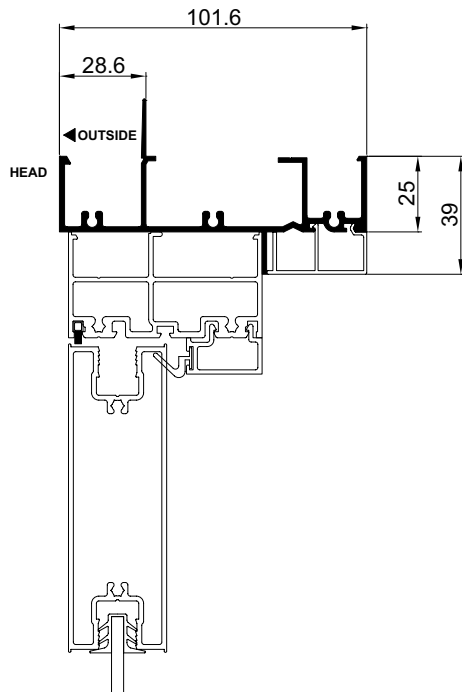

Please note that drawings are not to scale

Trend® Internal Offset Framing | A-CR-OF | Mk-4 | 1 Jul 2009

Confidentiality Notice: This document and the information it contains are copyright and confidential to Trend® Windows & Doors Pty Limited. Disclosure, use and copying in any form whatsoever, except as authorised by Trend® Windows & Doors in writing, are strictly prohibited. Patents and Design Registrations pending.

Cross Sectional Views

Trend® Internal Offset Framing | Aluminium Provincial Hinge Door Insert (Open In)

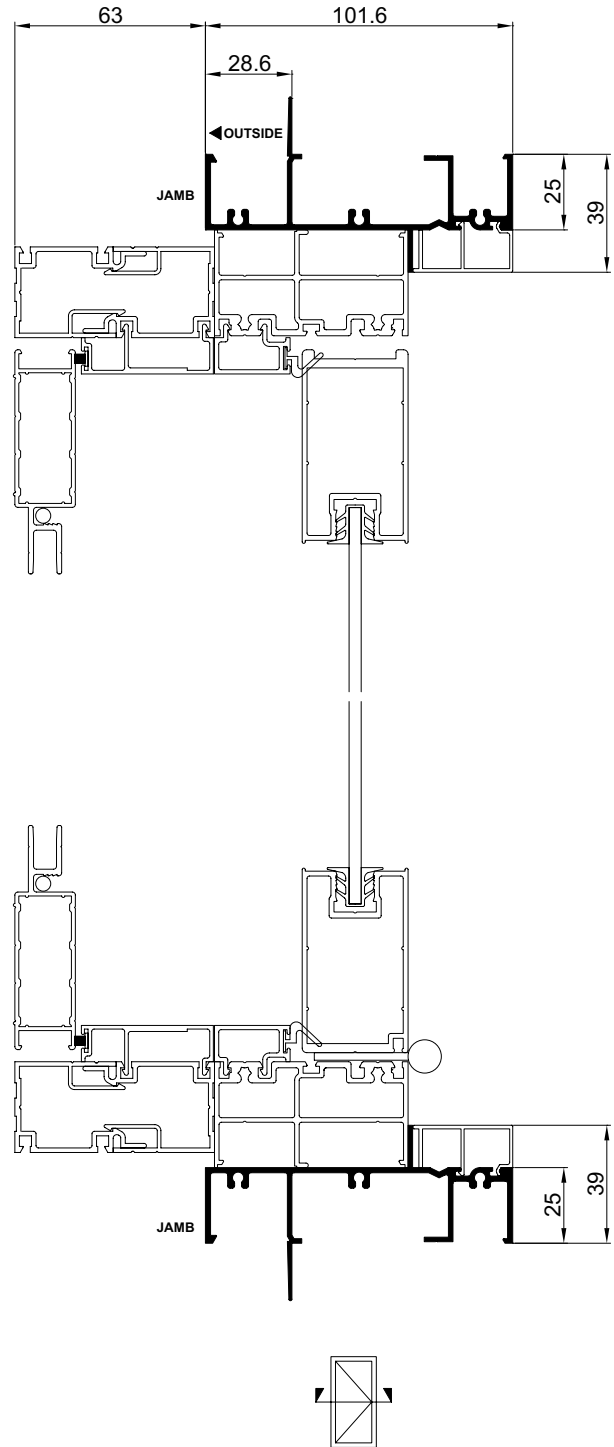
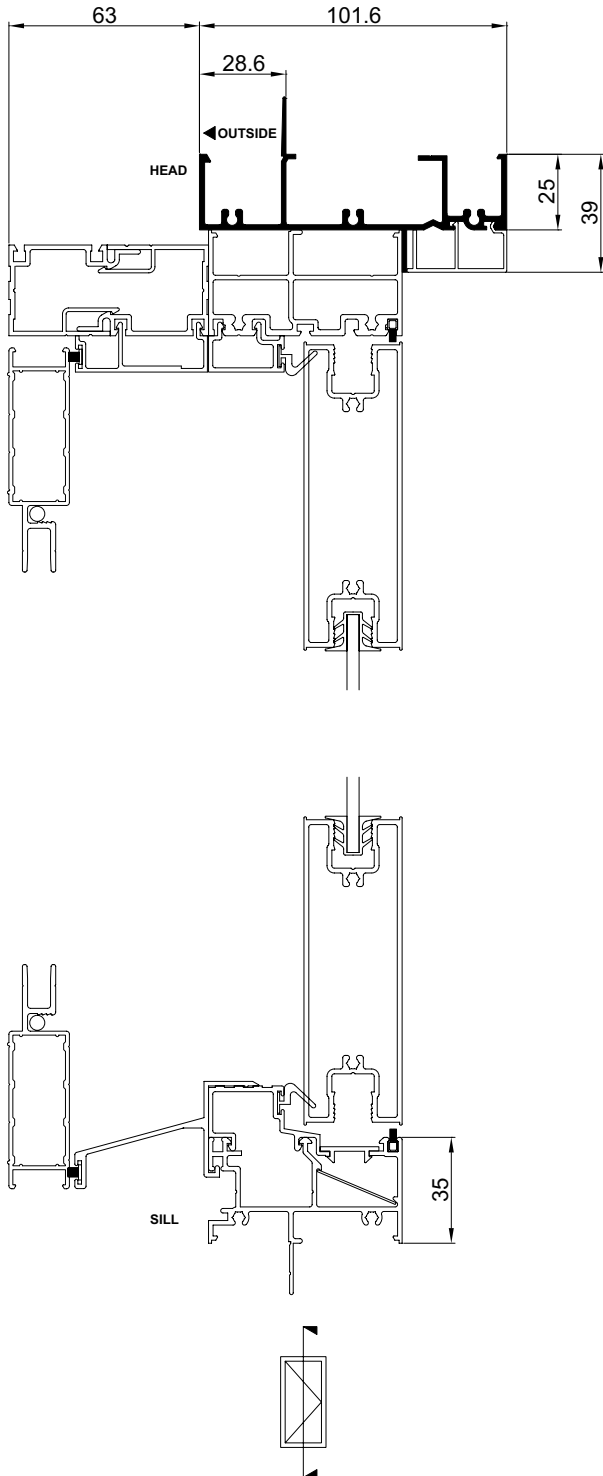

Please note that drawings are not to scale

Trend® Internal Offset Framing | A-CR-OF | Mk-4 | 1 Jul 2009

Confidentiality Notice: This document and the information it contains are copyright and confidential to Trend® Windows & Doors Pty Limited. Disclosure, use and copying in any form whatsoever, except as authorised by Trend® Windows & Doors in writing, are strictly prohibited. Patents and Design Registrations pending.