

Trend thermAL® Hybrid

Hinge Door

TECHNICAL DATA

Features & Benefits

Size Range

Ordering Details

Installation

Cross Sectional Views

Features & Benefits

Trend thermAL® Hinge Door

Glazing

Trend thermAL® is designed to accommodate up to 24mm double glazed units for maximum energy efficiency. With over 60 different glazing options there is a solution for any climate in Australia.

Among the lowest U-Values and SHGC available but at a significantly lower cost when compared to similar systems.

U-Value down to 2.3
SHGC range from 0.65 - 0.33
Cooling Efficiency 63%
Heating Efficiency 58%

Composition

Aluminium external surface for maximum strength which can be powder coated in a range of standard and designer colours for a bold external finish

Rigid polymer ERP™ is available in 3 standard steadfast colours to complement internal finishes with a subtle appearance but complementing the external finish.

Rigid polymer ERP™ internal surface designed to reduce energy transfer for highest energy efficiency

Rigid polymer ERP™ is impact modified to ensure minimal damage even during construction.

Rigid polymer ERP™ is pre-stressed to eliminate excessive shrinkage or expansion and is also UV stabilised to withstand the harsh Australian climates

Locks

Trend thermAL® Hinge Doors are fitted with a 3 point patio deadlock for security.

Hinges

The door is hung on special offset fast-fix hinges to eliminate binding. The door can also be supplied with Parliament hinges where the door is to swing out flush to brickwork.

Direction of Opening

The door can be ordered as open in or open out.

Safety Glazing

Toughened Safety A Grade glass with a visual motif at the mid point to provide added safety.

Frames

Maximum Door Height 2400mm
Maximum Door Width 980mm

Optional Insect Screen Door

Flyscreen door available

Options

Wide range of powdercoat finishes available including timber powdercoat finishes.

Protective Wrapping

Protective wrapping for delivery to site is a standard for all Trend thermAL® products.

ERP™ Colours

Anodic Natural Matt
White
Matt Stone Beige

Trend thermAL® Hinge Door have tested and passed the BAL-40 (Bushfire Attack Level) to withstand up to 40kW/m² of heat flux in bushfire areas

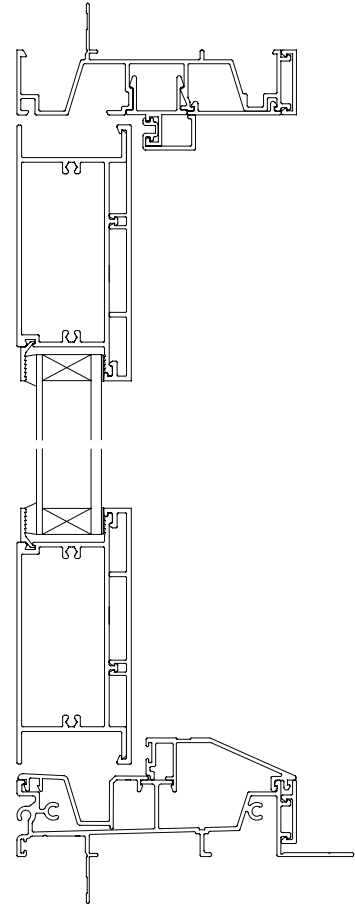

Please note that drawings are not to scale

Trend thermAL® Hinge Door | TAHD | Mk-1 | 24 Oct 2011

Size Range

Trend thermAL® Hinge Door

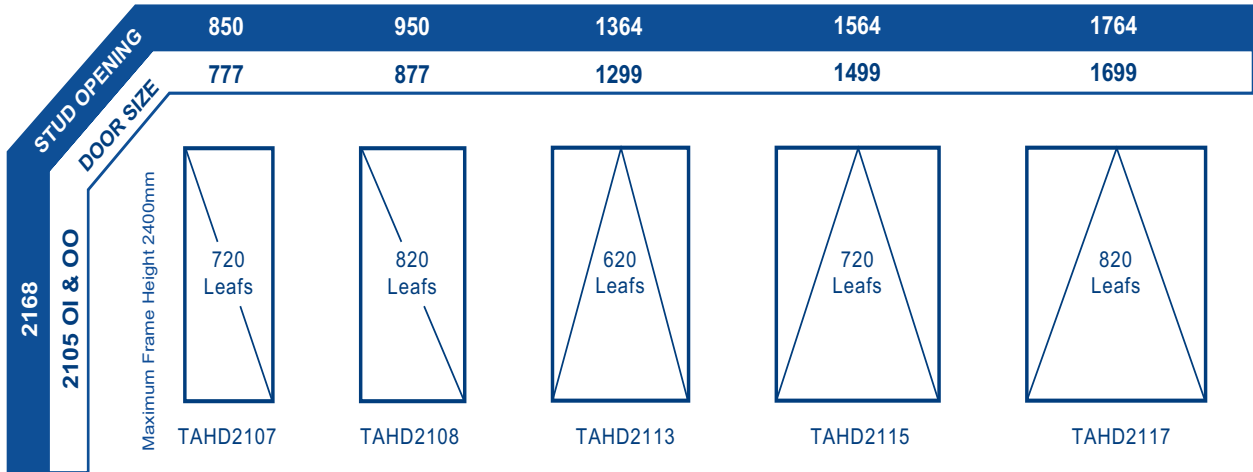

620, 720 & 820 DOOR LEAFS



All windows and doors are designed to 700pa velocity and 200pa water rating. For higher ratings consult Trend® Windows & Doors

Please note that drawings are not to scale

Trend thermAL® Hinge Door | TAHD | Mk-1 | 24 Oct 2011

Confidentiality Notice: This document and the information it contains are copyright and confidential to Trend® Windows & Doors Pty Limited. Disclosure, use and copying in any form whatsoever, except as authorised by Trend thermAL® Windows & Doors in writing, are strictly prohibited. Patents and Design Registrations pending.

Ordering Details

Trend thermAL® Hinge Door

All doors are illustrated as viewed from outside.

Codes shown are for plain doors. The first two numbers of code indicate approximate height, the last two numbers indicate approximate width.

Manufactured from aluminium and Rigid Polymer extrusion.

Sash Style Options:
Standard option, eg door code
TAHD2107

General:
Black hardware is supplied as standard

Note:
For information on different glass types or wind ratings, please contact a Trend Windows & Doors sales representative.

Pa refers to Pascal rating (wind pressure)

Option:
Sidelite and Highlites available

Installation

Trend thermAL® Hinge Door | Building In Detail | **Brick Veneer - 230mm wall**

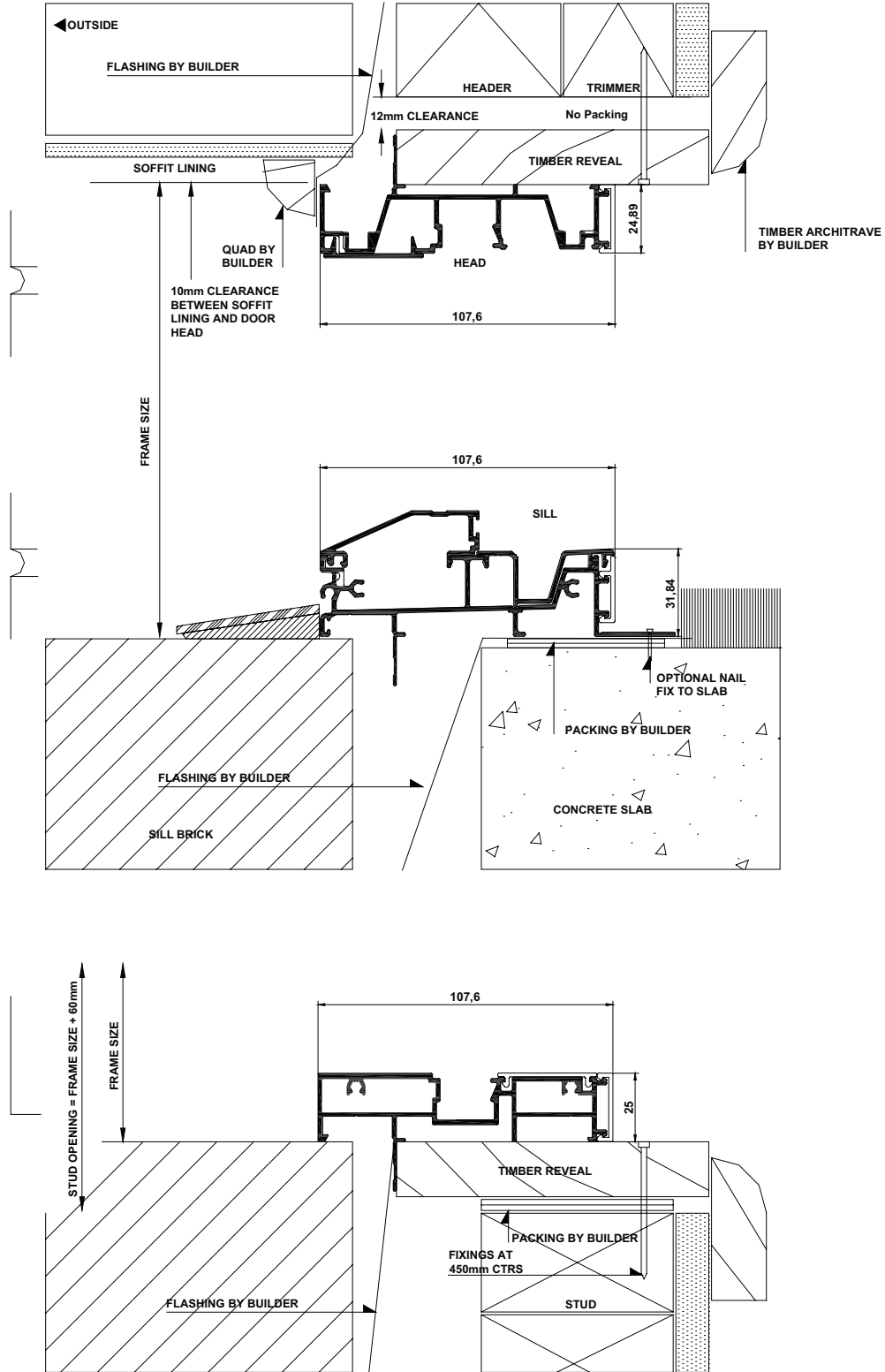

Please note that drawings are not to scale

Trend thermAL® Hinge Door | TAHD | Mk-1 | 24 Oct 2011

Installation

Trend thermAL® Hinge Door | Building In Detail | **Double Brick - 280mm wall**

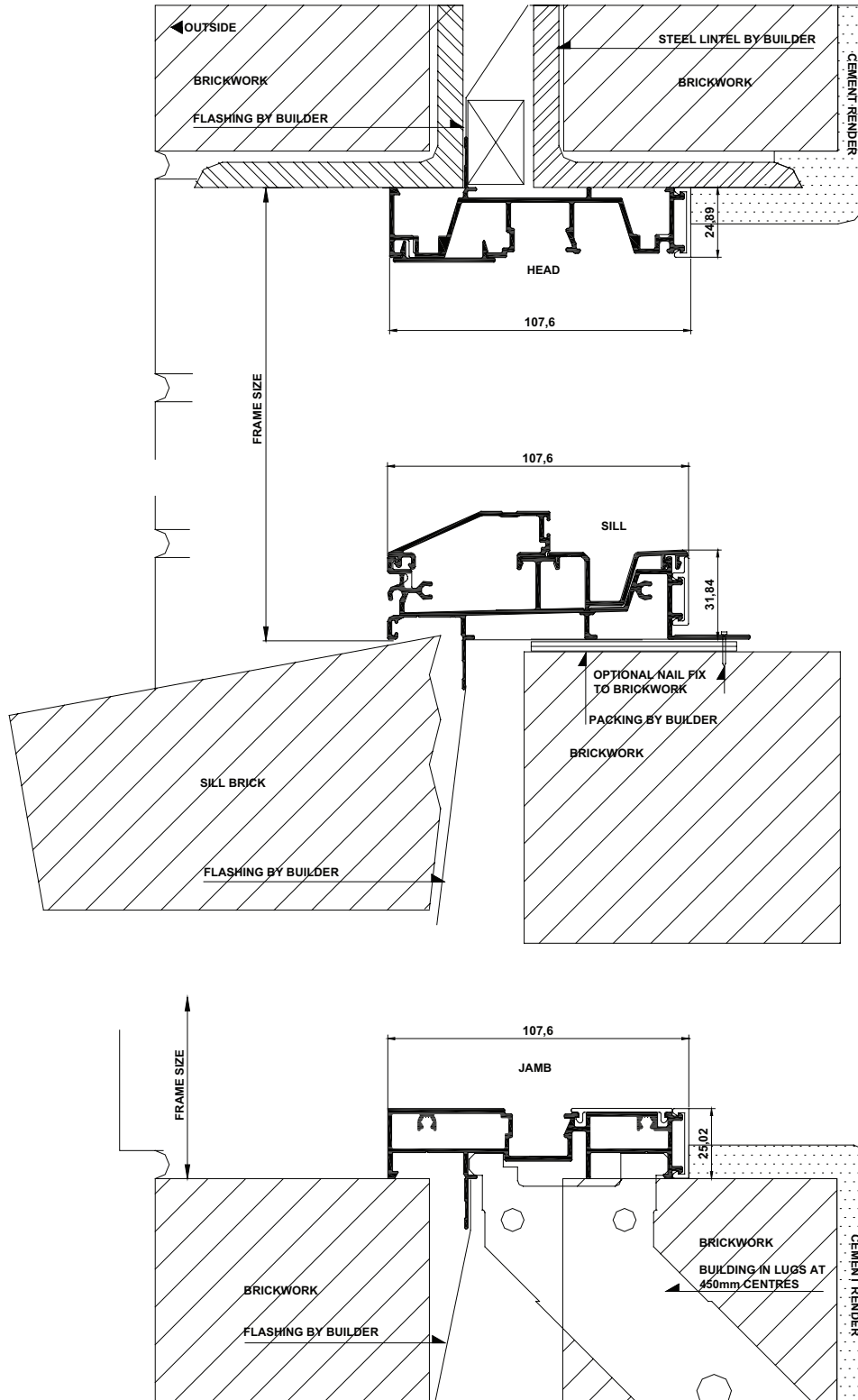

Please note that drawings are not to scale

Trend thermAL® Hinge Door | TAHD | Mk-1 | 24 Oct 2011

Installation

Trend thermAL® Hinge Door Window | Building In Detail | Aluminium Cladding on Studs

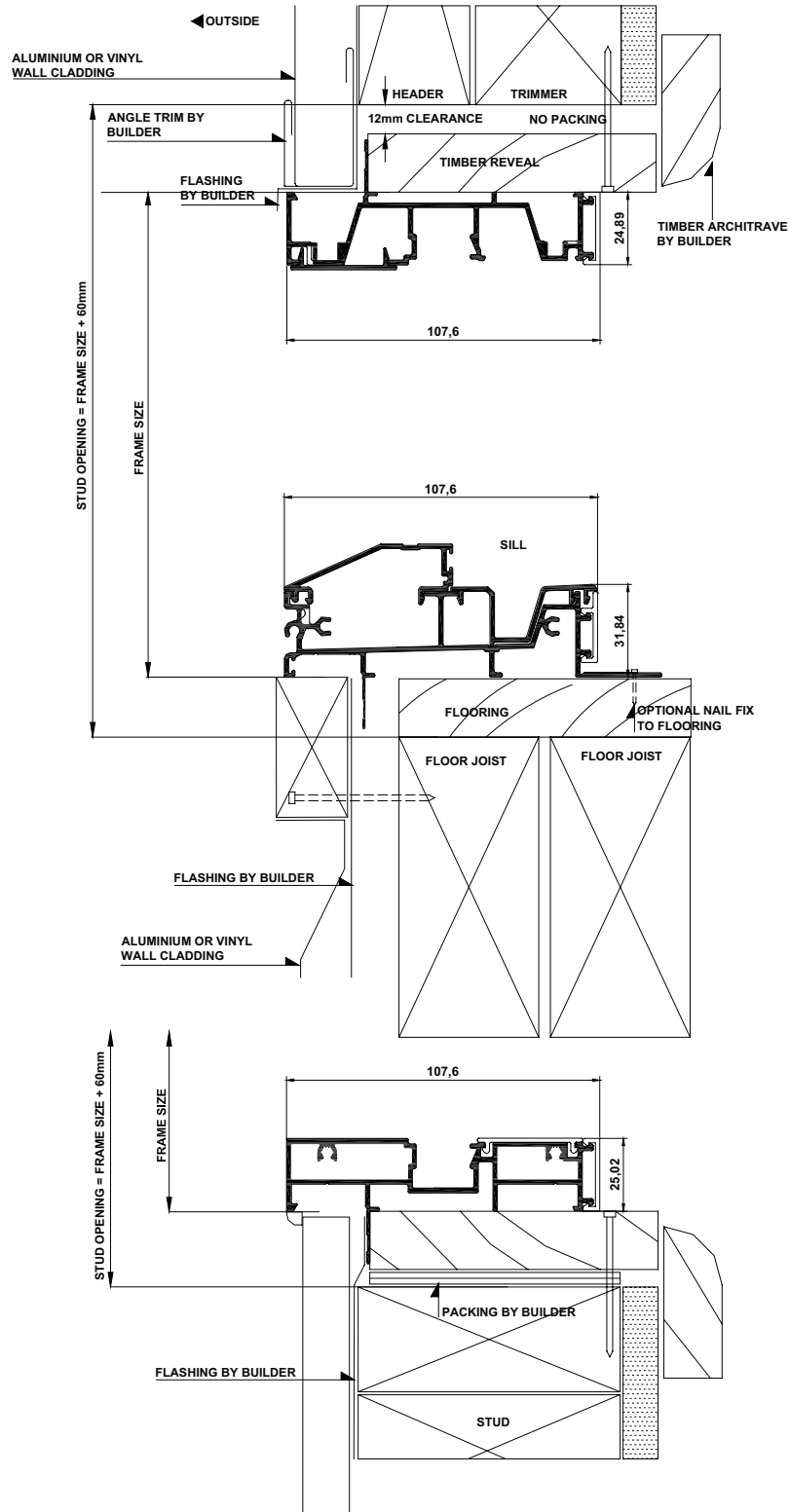

Please note that drawings are not to scale

Trend thermAL® Hinge Door | TAHD | Mk-1 | 24 Oct 2011

Confidentiality Notice: This document and the information it contains are copyright and confidential to Trend® Windows & Doors Pty Limited. Disclosure, use and copying in any form whatsoever, except as authorised by Trend thermAL® Windows & Doors in writing, are strictly prohibited. Patents and Design Registrations pending.

Cross Sectional Views

Trend thermAL® Hinge Door | **Single Lite - Open out**

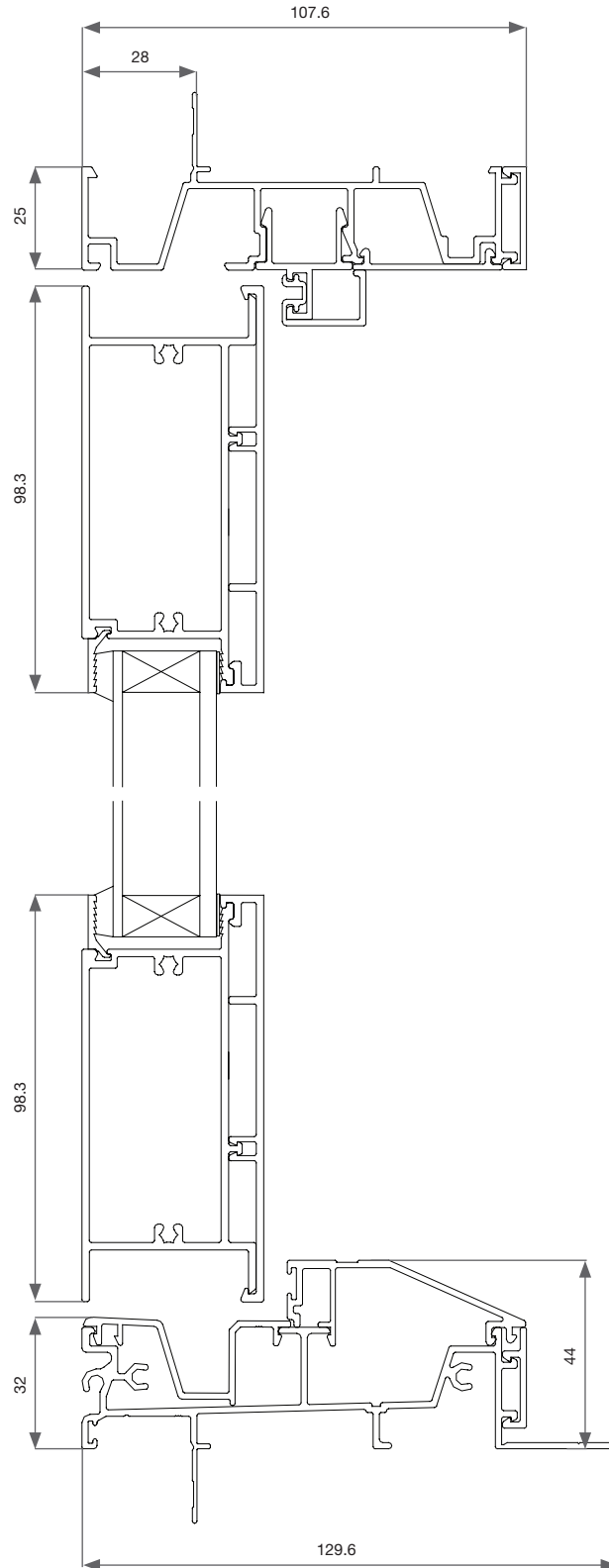

Please note that drawings are not to scale

Trend thermAL® Hinge Door | TAHD | Mk-1 | 24 Oct 2011

Confidentiality Notice: This document and the information it contains are copyright and confidential to Trend® Windows & Doors Pty Limited. Disclosure, use and copying in any form whatsoever, except as authorised by Trend thermAL® Windows & Doors in writing, are strictly prohibited. Patents and Design Registrations pending.

Cross Sectional Views

Trend thermAL® Hinge Door | **Single Lite - Open Out**

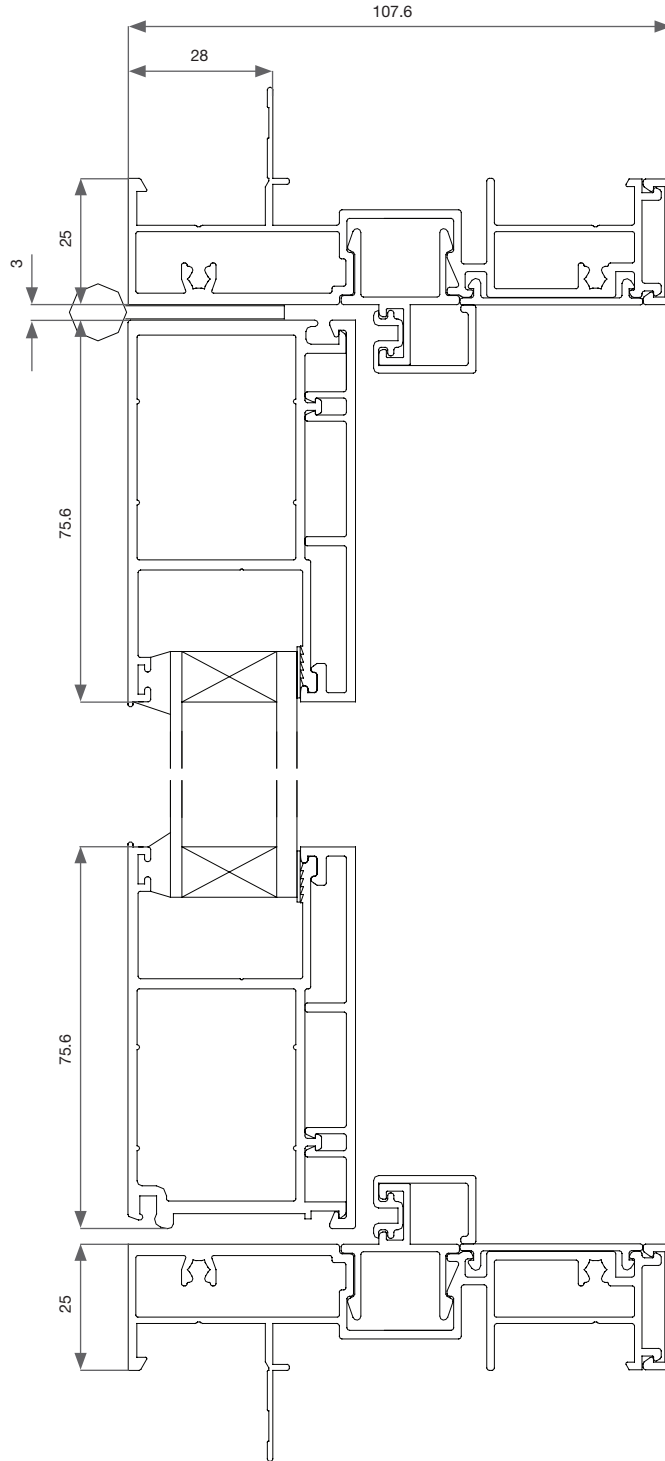

Please note that drawings are not to scale

Trend thermAL® Hinge Door | TAHD | Mk-1 | 24 Oct 2011

Confidentiality Notice: This document and the information it contains are copyright and confidential to Trend® Windows & Doors Pty Limited. Disclosure, use and copying in any form whatsoever, except as authorised by Trend thermAL® Windows & Doors in writing, are strictly prohibited. Patents and Design Registrations pending.

Cross Sectional Views

Trend thermAL® Hinge Door | 2 Lite - Open Out

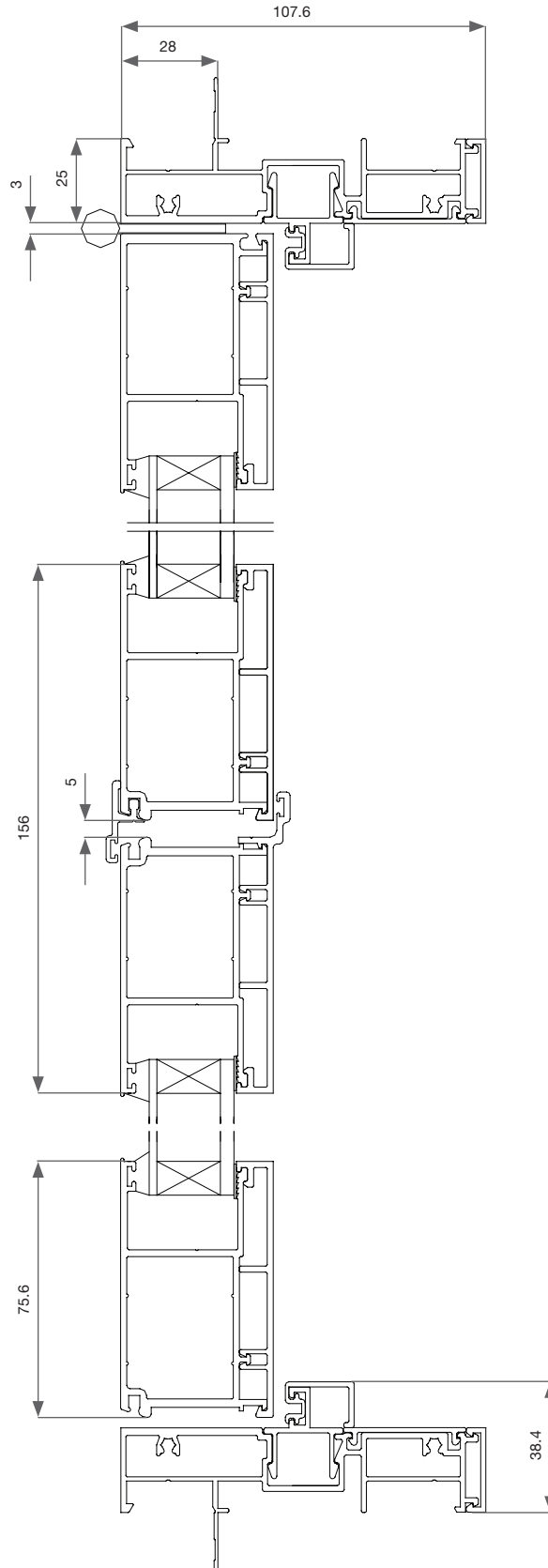

Please note that drawings are not to scale

Trend thermAL® Hinge Door | TAHD | Mk-1 | 24 Oct 2011

Confidentiality Notice: This document and the information it contains are copyright and confidential to Trend® Windows & Doors Pty Limited. Disclosure, use and copying in any form whatsoever, except as authorised by Trend thermAL® Windows & Doors in writing, are strictly prohibited. Patents and Design Registrations pending.

Cross Sectional Views

Trend thermAL® Hinge Door | **Single Lite - Open In**

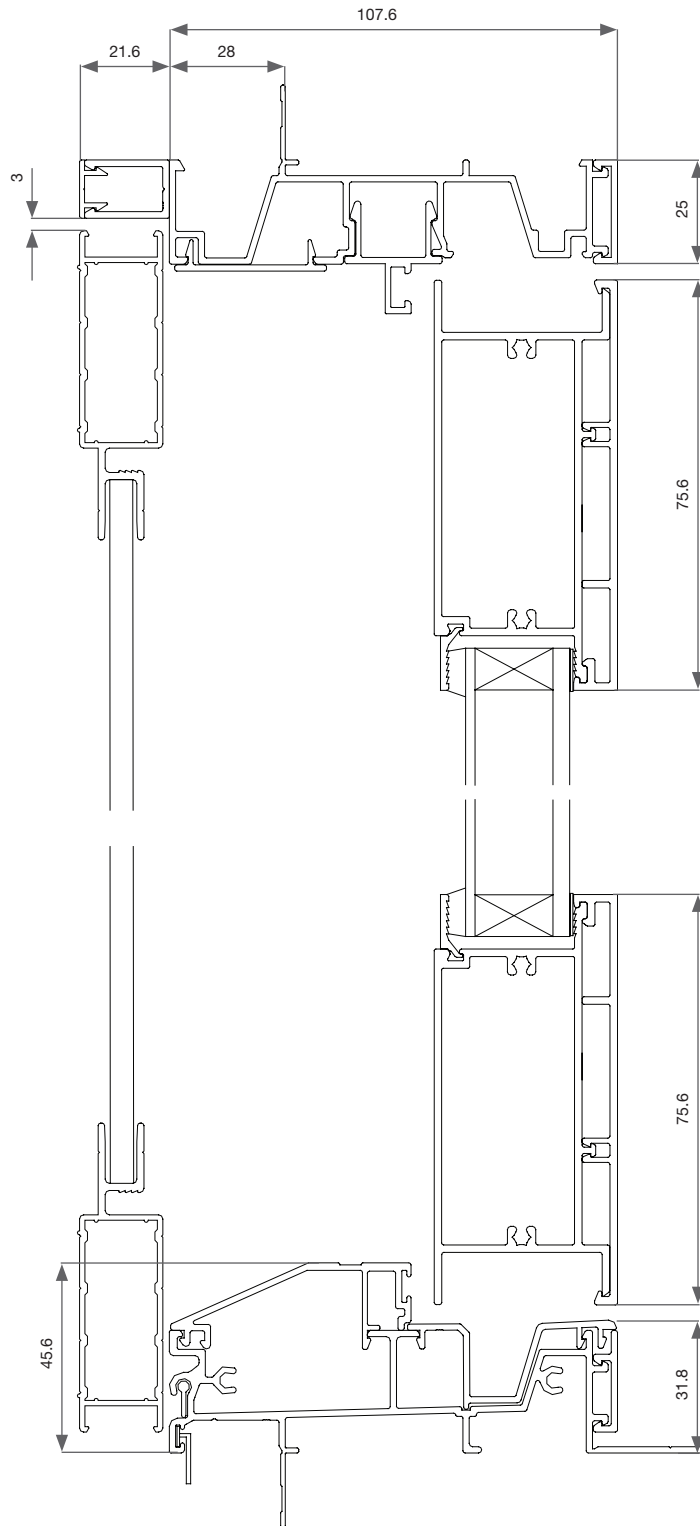

Please note that drawings are not to scale

Trend thermAL® Hinge Door | TAHD | Mk-1 | 24 Oct 2011

Confidentiality Notice: This document and the information it contains are copyright and confidential to Trend® Windows & Doors Pty Limited. Disclosure, use and copying in any form whatsoever, except as authorised by Trend thermAL® Windows & Doors in writing, are strictly prohibited. Patents and Design Registrations pending.

Cross Sectional Views

Trend thermAL® Hinge Door | **Single Lite - Open In**

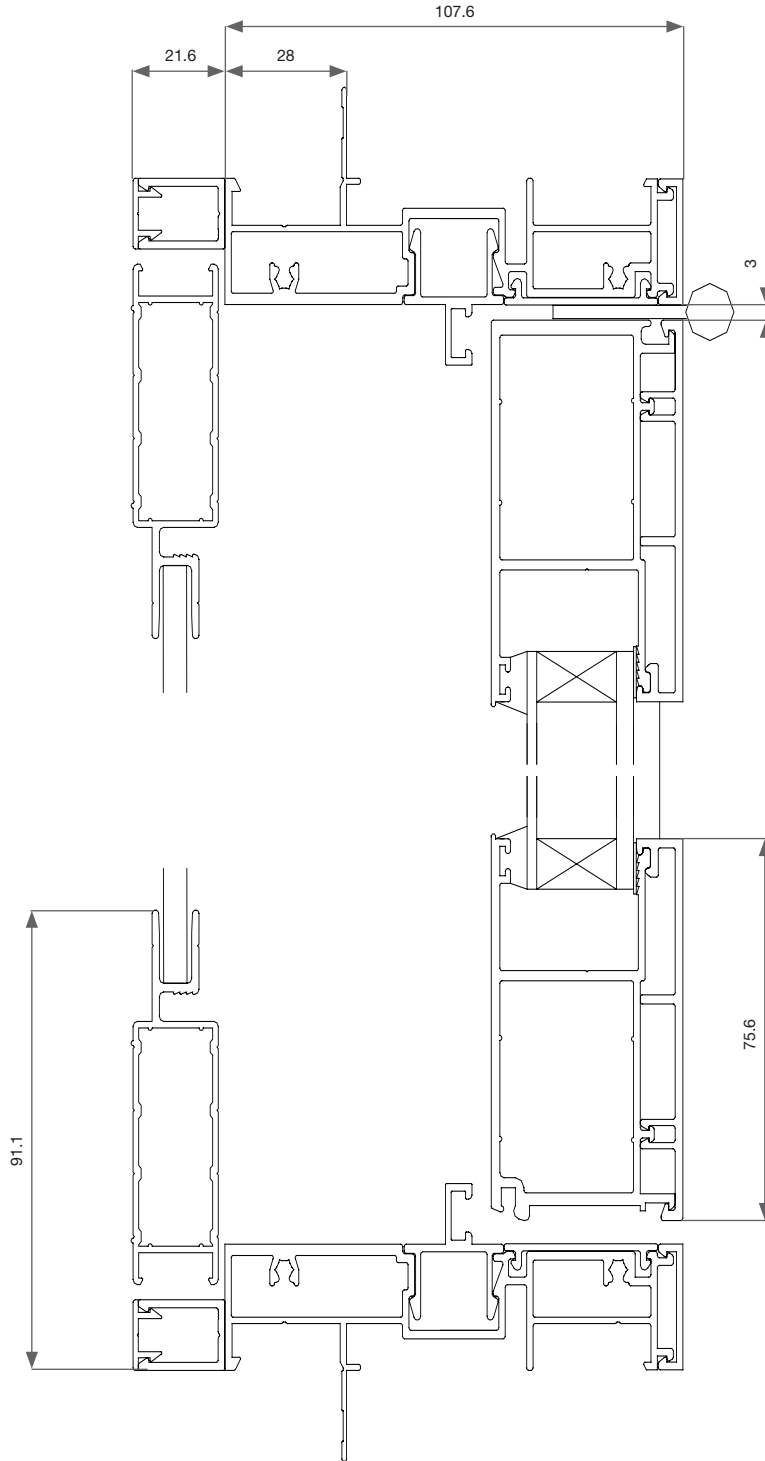

Please note that drawings are not to scale

Trend thermAL® Hinge Door | TAHD | Mk-1 | 24 Oct 2011

Cross Sectional Views

Trend thermAL® Hinge Door | 2 Lite - Open In

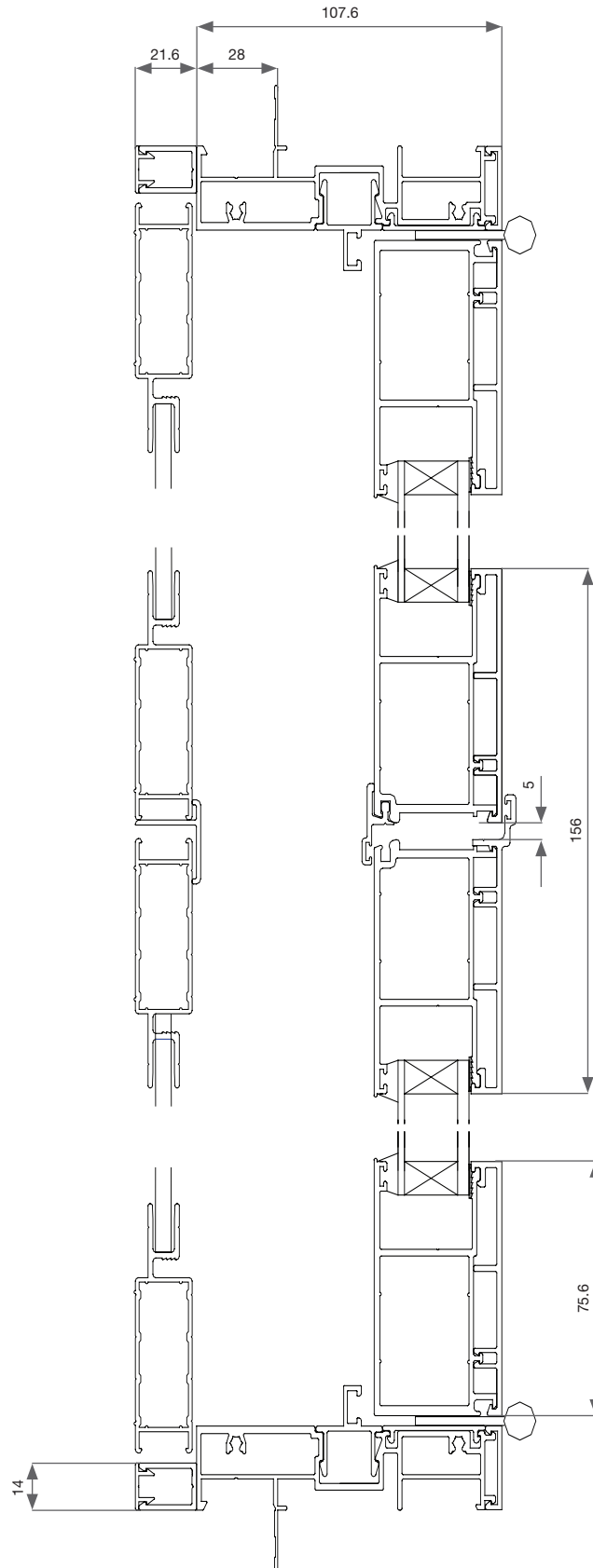

Please note that drawings are not to scale

Trend thermAL® Hinge Door | TAHD | Mk-1 | 24 Oct 2011