

1 Energy Efficiency Options

Trend® Thermashield® in various glazing styles are available to help reduce energy consumption. Trend® Thermashield® means greater control, bigger savings and most importantly one less thing to worry about. Energy efficient options to u-value of 5.878 and SHGC 0.425 are available for Trend® Provincial Hinged Door.

2 Acoustic options

SoundMizer® acoustic solutions in various STC ratings, are available to STC 35 for Trend® Provincial Hinged Door. SoundMizer® acoustic solutions can reduce aircraft, highway traffic, railway and other annoying noise problems. For information or technical details contact Trend®.

3 Safety Glazing

Toughened Safety A Grade Glass with a visual motif at the mid point to provide added safety. Laminated Glass is used in all non standard door sizes. Double Glazing is available for energy efficiency requirements.

4 Locks

Standard patio deadlock is fitted for security. Optional three point locking is also available.

5 Hinges

The door is hung on special offset fast-fix hinges to eliminate binding. The door can also be supplied with Parliment hinges where the door is to swing out flush to brickwork.

6 Direction of Opening

The door can be ordered as open in or open out.

7 Drained Sill

Standard on the door is the fully drained sill to improve the weathering on the door.

8 Matching Sidelites

Matching sidelites in the style of the swing doors are available as an option to Trend® Provincial Hinged Doors, as well as highlites, arches or other options.

9 Timber Entrance Door

Where there is the need for a Timber Entrance Door, the frame can accommodate a 40mm Exterior Timber Door in either open out or open in with the drained sill.

10 Options

Flyscreen door is available.

Colonial Bar and Federation Bar Layouts are available in Trend Ovolo system.

Wide range of powdercoat finishes including timber finishes available.

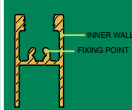
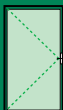

Features

ORDERING DETAILS

AP indicates Aluminium Provincial Door
APO indicates Ovolo glazing bars

- 1 When specifying door type, firstly select frame size, eg: AP898.
- 2 Select door style by placing the code after the frame size, eg: APO898/8L for Ovolo glazing bar or AP898/8L for Trend® Decorative bar.
- 3 Specify whether the door is Opening In or Opening Out by placing either -OI or -OO after the code, eg: AP898/8L-OO.
- 4 Sidelites are available in a 430mm standard size. To order place APF430 in front of style shown, eg: APFO430-4L for Ovolo glazing bar or APF430-4L for Trend® Decorative bar.

Black hardware is supplied as standard

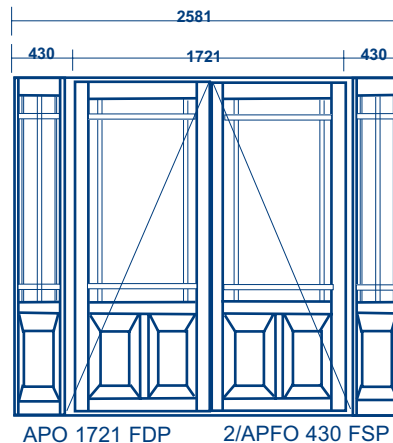

product data

section: AP

issue: MK - 1

revision: 28 Nov 2006

page:

2

Confidentiality Notice: This document and the information it contains are copyright and confidential to Trend Windows & Doors Pty Limited. Disclosure, use and copying in any form whatsoever, except as authorised by Trend Windows & Doors in writing, are strictly prohibited. Patents and Design Registrations pending.

Please note drawings are not to scale

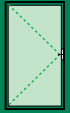

Drawn to show optional colonial detail. Codes are plain layout only.

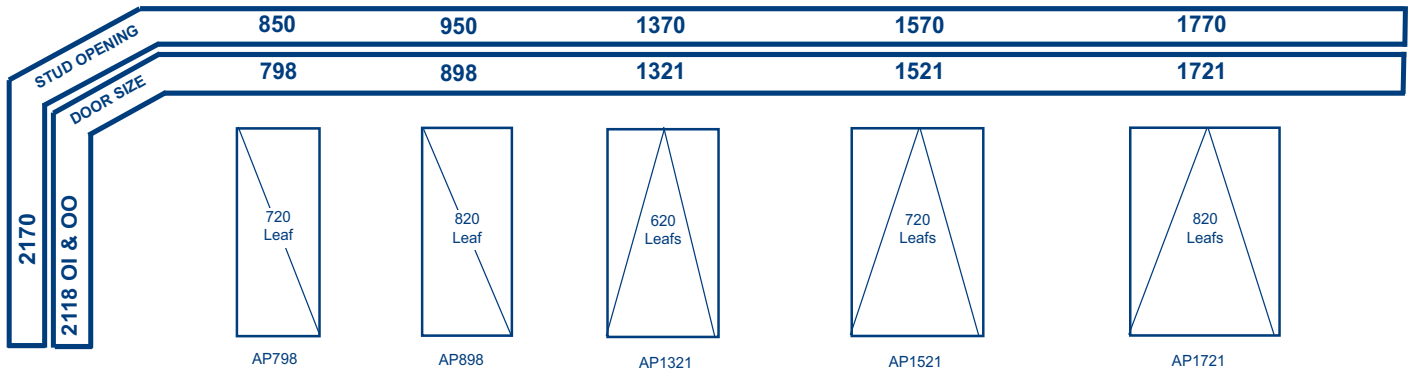

DOORS

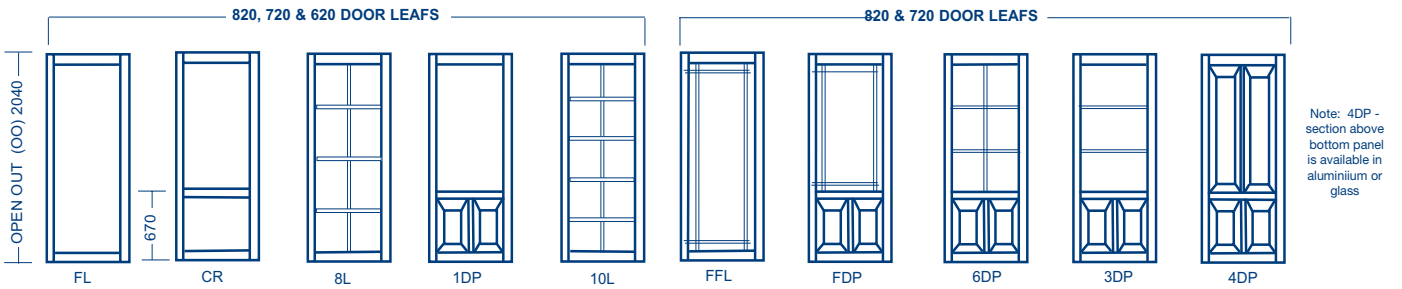

DOORS

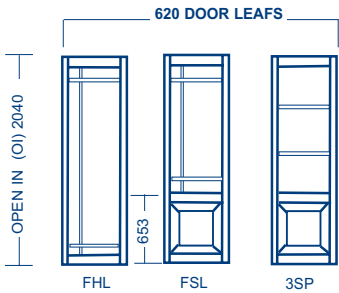

SIDLIGHTS

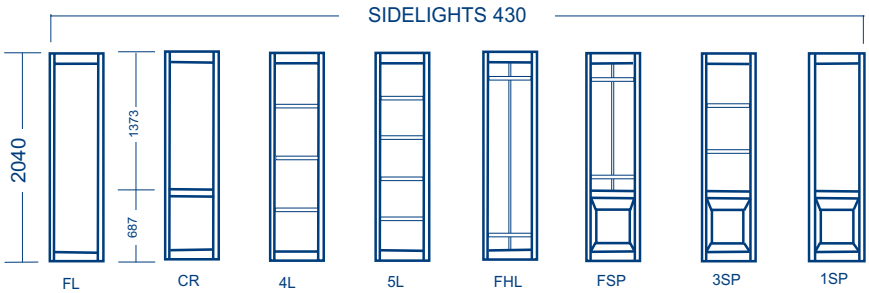

All windows and doors are designed to 700pa wind velocity and 150pa water rating. For higher ratings consult Trend Windows & Doors.